



42nd Annual Scientific Meeting



**Renaissance Indian Wells
Palm Springs, California**

April 10-13, 2016

***Eric Sokol, MD
Scientific Program Chair***

Jointly Provided by Oakstone Publishing, LLC



Join the SGS 2016 Twitter Conversation

During our 2016 conference all meeting participants are invited to join in the Twitter conversations. Post comments, reports and feedback on the meeting. All you need is a mobile device with an installed Twitter app or a web browser.

Setting up a Twitter Account

Go to www.twitter.com and sign up. You will need to enter information and accept terms of service. You will also need to verify your email address. Twitter provides a wizard set up and asks you to follow five people. It states that it is optional though it does not give you an option to skip it. If you wish to follow the messages at the conference search for #SGS2016.

Install a Twitter Application on your mobile device

Go to <http://twitter.com/download> and select your device. If you do not wish to install an app for Twitter, you can still use Twitter within your web browser.

Sending a Tweet

You can do this with the Twitter app on your mobile device or on the Twitter website. On the website you can post a tweet by clicking on Home and then type inside the left-hand box that says "compose new tweet". You are limited to 140 characters in a single tweet. At the end of each message you must put **#SGS2016**. For example:

Keynote speaker Dr. Smith starting now standing room only - #SGS2016

Please follow these guidelines:

- Messages must be about the meeting content or activities
- Messages cannot contain personal information
- Messages cannot be a personal attack against another person

***We hope you will join the Twitter conversation
by following @Gynsurgery and connect using #SGS2016***

Join/Follow the 2016 SGS Fellow Scholars:

Gretchen G. Collins, MD
Arthur Michael ("Mitch") Dizon, MD
Ahmed Y. Hefnawy, MD
Michelle M. Q. Pacis, MD, MPH
Chandhu Paka, MD, FACOG
Courtney J. Steller, DO

Supported by Coloplast, CooperSurgical, Intuitive Surgical,
OBG Management, and SGS Education Fund

— Table of Contents —

Welcome from the President	2
Mission Statement	3
Honored Mentors	4
Board of Directors	12
Scientific Program Committee	13
Renaissance Indian Wells Floor Plans	14
Sponsors & Industry Events	16
What You Need to Know	18
General Meeting Information	19
Social Activities	20
CME Information	21
New SGS Members	23
Member Candidate Presentations	24
Women's Council Presentation	25
TelInde Lecture	27
Keynote Lecture	28
Special Guest Lecture	29
Sunday Sessions	30
Monday Sessions	31
Tuesday Sessions	45
2015 SGS Scientific Program Award Winners	52
Wednesday Sessions	53
Video Café	62
Non-Oral Posters	65
SHARE Donors	76
SGS Membership	85
Active	87
Life	106
Associate	110
Honorary	116
In Memoriam	117
Exhibitors	119
SGS Administrative Staff	128

— Message from the President —



Greetings from sunny California! As President of the Society of Gynecologic Surgeons, it is my honor to welcome you to the 42nd Annual Scientific Meeting in Palm Springs, California April 10th-13th, 2016. Eric Sokol and the SGS Program Committee have put together what is going to be an informative, exciting and maybe even a little controversial program for the scientific meeting and postgraduate courses this year.

One primary component of the SGS mission is to promote excellence in gynecologic surgery. Innovation, when properly applied, is one of the key factors in furthering surgical excellence and, in that spirit, the theme of our meeting this year is *"Innovative ways to improve surgical care, research, and education in gynecologic surgery."* The Keynote and TeLinde Lecturers will expound upon this topic looking at different sides of the coin, addressing how to promote what works and how to make surgery work more effectively. The SGS debate series has always been lively and this year's will be no exception-- with 4 renowned surgeons discussing what the patient expects from surgical innovation. The oral and poster presentations, video sessions and roundtable discussions span the spectrum of gynecologic surgery (including general gynecology, oncology, minimally invasive surgery, reproductive endocrinology and urogynecology). Postgraduate courses on advanced minimally invasive surgical techniques for straight stick laparoscopy, vaginal hysterectomy and pelvic pain will be of interest to both the young and experienced gynecologic surgeons alike. Finally, we are sure you are going to be excited about our innovations this year for the typically early morning round table discussions.

The scientific sessions and social program, as always, will provide a unique opportunity to collaborate with old friends and meet new ones. The glamour and stark beauty of the Palm Springs area -- with world class golfing, amazing outdoor recreation and incredible dining all set against the stunning backdrop of the Renaissance Indian Wells Resort and Spa will leave you spellbound long after the meeting has ended. I look forward to seeing you all in Palm Springs in 2016, as we learn how and when to innovate so that we can continue to provide the best surgical care to our patients.

Most Sincerely,

A handwritten signature in dark ink, appearing to read 'Andrew Walter'.

Andrew Walter, MD
SGS President

— Mission Statement —

The mission of the Society of Gynecologic Surgeons is to promote excellence in gynecologic surgery through acquisition of knowledge and improvement of skills, advancement of basic and clinical research, and professional and public education.

SGS is a Society with a strong belief in mentorship. On the following pages we are pleased to recognize the mentors who have been honored by those whose careers they helped develop while also fostering the mission of SGS.



In Memoriam

Marvin H. Terry Grody, MD, July 2015
Robert C. Park, MD, October 2015
Richard E. Symmonds, MD, February 2016

— Honor Your Mentor —



**John O. L.
DeLancey, MD**

Your dedication to: understanding problems, new and old; patients; learners; and colleagues is truly inspiring. I am honored to be a mentee, colleague and friend.

Kris Strohbehn, MD



J. Andrew Fantl, MD

Thank you for the many years of support, guidance and inspiration, and for introducing us to SGS!

Joe Schaffer, MD, and
Marc Togliola, MD

— Honor Your Mentor —

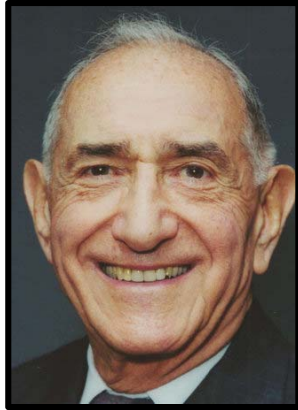

**Marvin H. Terry
Grody, MD**

*I am grateful for your mentorship
and your surprising advice for me
to pursue a career in laparoscopic
surgery.*

Ted Lee, MD



Douglass S. Hale, MD

*Thank you for your continuous
guidance and support.*

Your FPMRS Fellows and Residents,
2012 - present

— Honor Your Mentor —



**Michale H. Heit,
MD, PhD**

*Thank you for your continuous
guidance and support.*

Your FPMRS Fellows and Residents,
2012 - present



Cheryl B. Iglesia, MD

*Your unending enthusiasm and
positivity allow us to be the
best version of ourselves. Your
mentorship and leadership
have opened countless
opportunities. Thank you for
everything.*

Amy Park, MD; Andrew Sokol, MD; Robert Gutman, MD; Lee
Richter, MD; Bela Kudish, MD; David Shveiky, MD; Danielle
Antosh, MD; Patrick Nosti, MD; Ladin Yurteri-Kaplan, MD;
Jeannine Miranne, MD; Kate Smithling, MD; Karl Jallad, MD;
Charelle Carter, MD; Kate Meriwether, MD

— **Honor Your Mentor** —



**Kimberly Kenton,
MD, MS**

*"Generosity is the best
investment" -Diane Von
Furstenberg*

*This shines through in your
tireless dedication, motivation,
guidance, and friendship!*

With love, your former fellows- Maggie Mueller, MD; Melinda Abernethy, MD, MPH; Cynthia Fok, MD, MS; Jackie Cunkelman, MD, MPH; Olga Ramm, MD, MS; Megan Tarr, MD, MS; Shameem Abbasy, MD, MPH; Thythy Pham, MD, MS; Lior Lowenstein, MD, MS; Shika Dooley, MD, MS; Leslie Rickey, MD, MPH; Tina Mahajan, MD; Beth Mueller, MD, MS; Eman Elkadry, MD; Fareesa Khan, MD



Paul M. Magtibay, MD

*Paul, we thank you for the
opportunity to learn the breadth
of gynecologic surgery from you!*

Your grateful Mayo Scottsdale
Urogynecology and GYN surgery
Fellows

— Honor Your Mentor —



**Karen L. Noblett,
MD, MAS**

*To an outstanding mentor,
clinician, and friend, thank you
for training each of us.*

Your fellows, 2004-2015



Joseph Schaffer, MD

*Thank you for your leadership,
mentorship, teachings and all the
good times shared during our
years in training and beyond.*

Fellows, 2000-2015

— Honor Your Mentor —

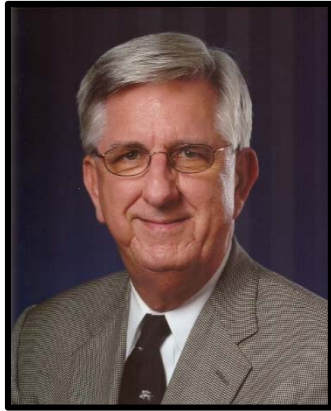

Bob Shull, MD

Thank you Dr. Shull for your dedication to teaching us about surgery and the world around us!

Sincerely,
Fellows and Colleagues from
Scott & White

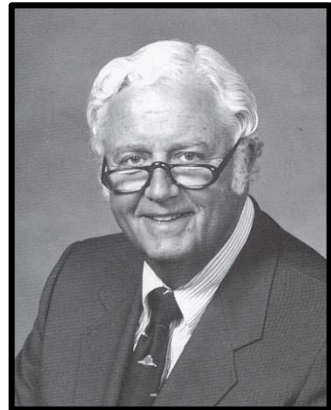

**Professor John D.
Thompson, MD**

Thank you for teaching us the art of listening to patients, as well as mentoring us in the skills and compassion necessary to care for them.

Lisa M. Peacock, MD and
Anne K. Wiskind, MD

— Honor Your Mentor —

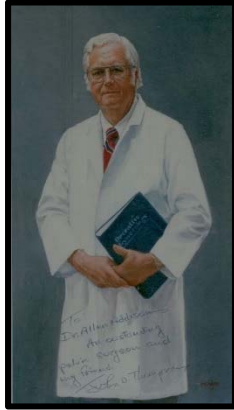

John D. Thompson, MD

Incomparable surgeon, Superb mentor, Valued friend.

W. Allen Addison MD



Babak Vakili, MD

Thank you for your mentorship and commitment to our education.

Your CCHS OB/GYN Residents

— Honor Your Mentor —



Stephen B. Young, MD

Esteemed Teacher, Mentor, and Dear Friend, Words cannot express our gratitude for your mentorship, invaluable teaching, and guidance in shaping our skills. Your legacy will be carried on for generations to come.

With the highest gratitude and respect,

Your UMASS Fellows 2004-2011
LL, SK, EWL, DI



**The Residents and
Fellows Who Taught
Me So Much and a
Former Duke Nurse
Who With Their Help
Has Kept Me Straight**

W. Allen Addison, MD

—Board of Directors—

Executive Committee

President – Andrew J. Walter, MD

President-Elect – Vivian Sung, MD

Secretary/Treasurer – John B. Gebhart, MD

Assistant Secretary/Treasurer – Rajiv Gala, MD

Immediate Past President – Stephen Metz, MD

Past President – Holly E. Richter, PhD, MD

Member-At-Large – Ted Lee, MD

Member-At-Large – Michael Diamond, MD

Executive Director – Nancy R. Frankel, PhD

Committee Chairs

Membership Committee – Jeffrey Cornella, MD

Bylaws Committee – Lily A. Arya, MD

Research Committee – Miles Murphy, MD

Education Committee – Michael Moen, MD

Postgraduate Committee – Kris Strohbehn, MD

Scientific Program Committee – Eric Sokol, MD

—2016 Scientific Program Committee—

Scientific Program Chair – Eric Sokol, MD
Scientific Program Co-Chair – Robert Gutman, MD
SGS President – Andrew Walter, MD
SGS Immediate Past President – Stephen Metz, MD
SGS President – Elect Vivian Sung, MD
Past Scientific Program Chair – Charles Rardin, MD
Abstract Review Chair – Brittany Star Hampton, MD
Video Review Chair – Peter Rosenblatt, MD
SGS Staff – Lennie Siegel, BBA, CPA
Executive Director – Nancy R. Frankel, PhD

Video Reviewers

Peter Rosenblatt, MD – Chair
C. Bryce Bowling, MD
Geoffrey Cundiff, MD
Dobie Giles, MD
Ted Lee, MD
Vincent Lucente, MD
Catherine Matthews, MD
Andrew Sokol, MD

Abstract Reviewers

Brittany Star Hampton, MD – Chair
Andrew Cassidenti, MD
Michael Diamond, MD
Elisabeth Erikson, MD
Lennox Hoyte, MD
Christina Lewicky-Gaupp, MD
Kristen Matteson, MD
Tyler Muffy, MD
Amy Park, MD
Rachel Pauls, MD
Karl Tamussino, MD

Crystal Ballroom

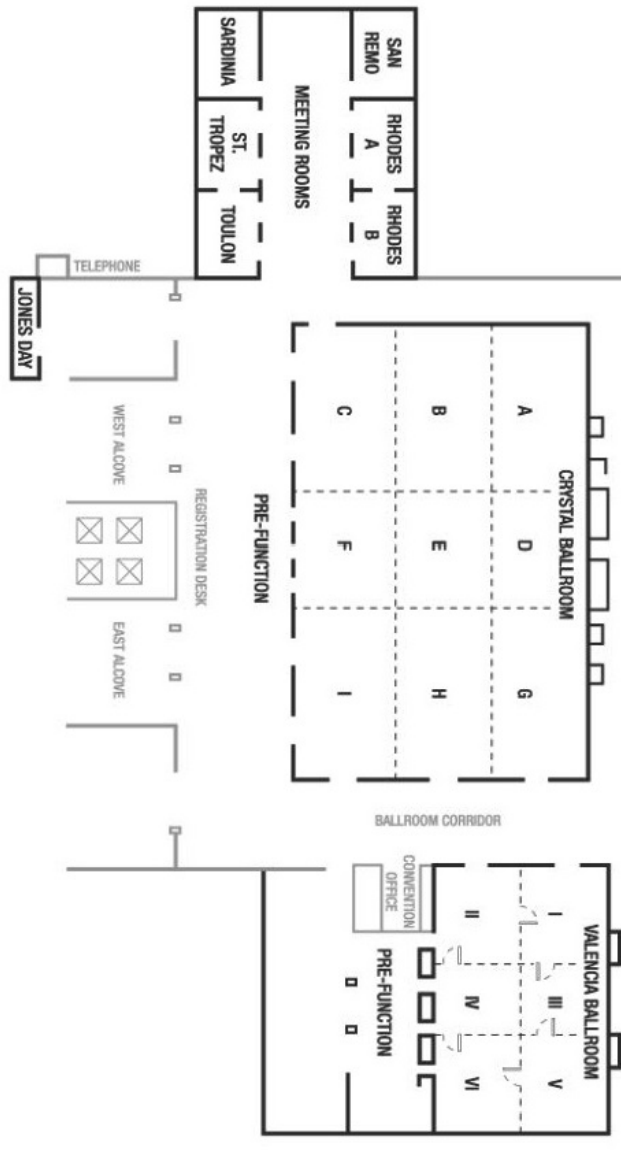

Esmeralda Rooms

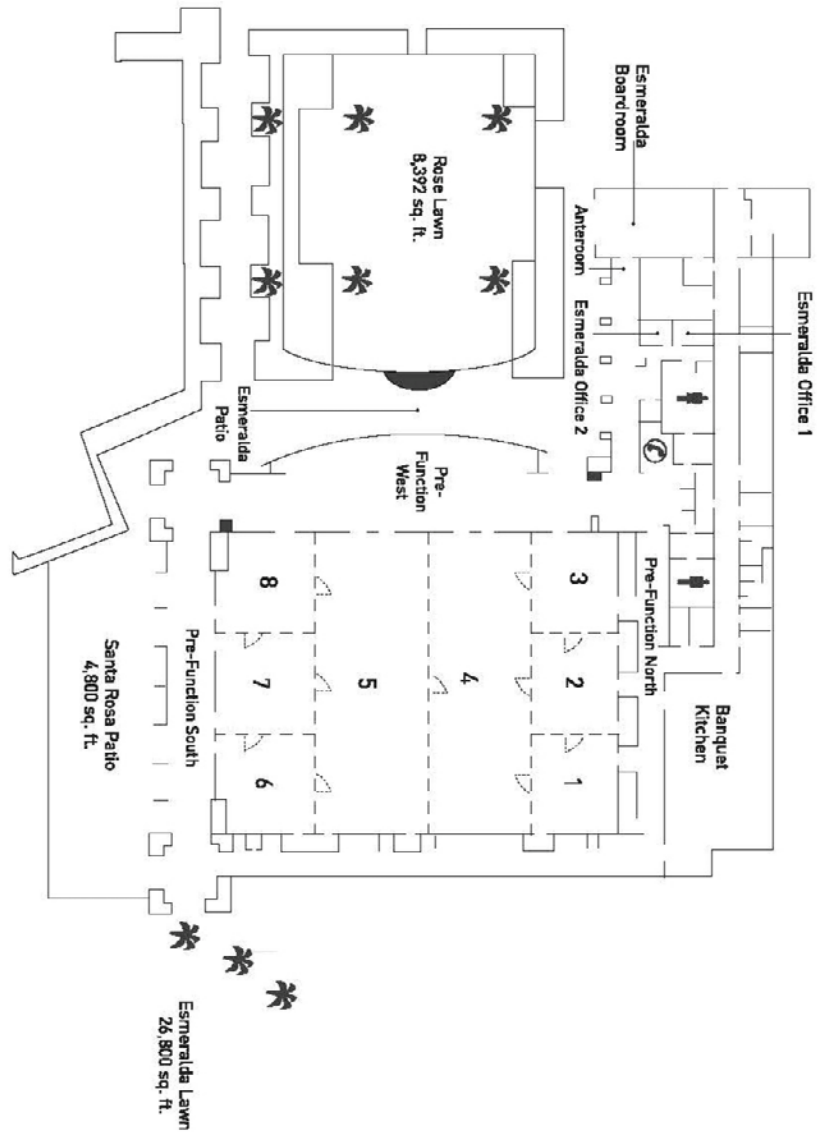

— Sponsors —

SGS thanks our premier sponsors for their support.

Diamond Sponsorship



Gold Sponsorship



Silver Sponsorship



Bronze Sponsorship



— Sponsors —

**Industry Events
(Non-CME)**

Tuesday, April 12

**Industry Breakfast Symposium
Stress Incontinence in 2016: A Changing Paradigm**

*6:15 AM – 7:25 AM
Crystal Ballroom I*

6:15 AM – Breakfast

6:30 AM – Program

Topics

- Overview of Treatment Options for SUI
- Initial Experience with the Altis® Single Incision Sling- from Monarc™ and MiniArc™
- Panel Discussion: Approaches to the patient conversation

Speakers

Mark D. Walters, MD
Andrew Cassidenti, MD
Beri Ridgeway, MD
Bernard Taylor, MD

Supported by Coloplast

— **General Meeting Information** —

Welcome to the SGS 2016! So that you may take full advantage of everything this meeting has to offer, please note the following:

Bar Codes: Your attendee badge will have a bar code. This bar code will make your interactions with the exhibitors more efficient. Each coded badge contains the information that the exhibitors need to register you with their company and to ensure that you are identified correctly in their records.

Mobile Apps: We are pleased to offer the SGS mobile meeting app for the 2016 scientific meeting. Search for specific abstract authors and sessions, abstracts, and get updates on any changes.

The mobile itinerary app is available as both a native iOS (iPhone/iPad) app through the iTunes App Store, or as an HTML5 Web app for all major mobile devices (iPhone/iPad, Android, Blackberry 7 and above). Once either version is downloaded to your device, it can be run without the need for an active Internet connection. In addition, you can sync an itinerary that you created online with the app by entering your unique itinerary name.



For optimal use, we recommend: iPhone 3GS, iPod touch (3rd generation+), iPad iOS 4.0 or later. You can download the MyItinerary app by searching for “ScholarOne” in the App Store directly from your mobile device. Alternatively, you can access the link below or scan the QR code to access the iTunes page for the app.

<http://itunes.apple.com/us/app/scholarone-my-itinerary/id497884329?mt=8>

Once the MyItinerary app is downloaded, select the meeting “SGS 42nd Annual Scientific Meeting”

Watch for the daily “Tweet” contest!



**Win a prize by
following the instruction in the Tweet.**

— **General Meeting Information** —

Registration Information

Saturday, April 9: 5:00 PM – 7:00 PM
(Postgraduate Courses Only)

**Crystal Registration
Desk**

Sunday, April 10: 7:00 AM – 7:00 PM

**Crystal Registration
Desk**

Monday, April 11: 6:00 AM – 3:00 PM

**Esmeralda
Registration Desk**

Tuesday, April 12: 6:00 AM – 1:30 PM

**Esmeralda
Registration Desk**

Wednesday, April 13: 6:00 AM – 12:00 PM

**Esmeralda
Registration Desk**

Speaker Ready Room Information/ Video Café/Internet Café

Esmeralda Boardroom

Sunday, April 10: 4:00 PM – 7:00 PM

Monday, April 11: 6:30 AM – 6:30 PM

Tuesday, April 12: 6:30 AM – 6:00 PM

Wednesday, April 13: 6:30 AM – 12:00 PM

Exhibit Set-up Times

Sunday, April 10 1:00 PM – 6:00 PM

Esmeralda Ballroom 5-8

Monday, April 11 6:00 AM – 8:30 AM

Esmeralda Ballroom 5-8

Exhibit Hall Hours

Esmeralda Ballroom 5-8

Monday, April 11: 9:00 AM – 3:00 PM

Monday, April 11: 7:00 PM – 8:30 PM

Tuesday, April 12: 9:00 AM – 1:00 PM

Poster Set-up Time

Sunday, April 10: 4:00 PM – 9:00 PM

Santa Rosa Patio

Badge Color Key

Red – SGS Member

Orange – Non-Physician

Black – Non-Member

Yellow – Spouse/Guest

Blue – In Training

Green – Exhibitor

— **Social Activities** —

Sunday, April 10

6:00 PM – 7:00 PM **Welcome Reception** *Cascade Landing*
(included with registration)

Monday, April 11

6:45 PM – 7:15 PM **Awards Ceremony** *Esmeralda Ballroom 1-4*

7:15 PM – 8:30 PM **President's Reception** *Esmeralda Ballroom 5-8*
(All SGS attendees, guests and exhibitors are invited.)

Tuesday, April 12

1:45 PM – 6:45 PM **Mountain Biking**
(Ticketed Event - \$140)
Bus Leaving from Front Entrance near the flagpole

2:00 PM – 6:45 PM **SGS Golf Tournament**
(Ticketed Event - \$189)
Indian Wells Celebrity Golf Course
Walk to course – Shotgun start at 2:00 PM

7:00 PM – 9:30 PM **Evening with the Stars**
(Ticketed Event - \$100)
Stir Lounge

— CME Information —

Program Chair: Eric Sokol, MD

Target Audience: Gynecologic Surgeons

Program Goal: The goal of the annual scientific meeting is to provide member and non-member attendees with a forum for the latest and most innovative developments in gynecologic surgery. This will be accomplished through lecture, slide, video and poster presentations. Oral presentations are followed by a discussion and a question and answer session.

To Obtain Your CME: CME evaluations will be conducted electronically. You will receive an email within one week following the end of the SGS meeting requesting you to fill out an evaluation to attain your CME credits. Even if you do not wish to request CME please fill out the evaluation questions. Your feedback is critical to us to help identify topics and speakers of interest to you. In order to receive CME credits, evaluations must be completed.

If your preferred email address is not in your current SGS profile, please stop at the SGS registration desk in the Esmeralda Foyer during the meeting to update your email address. After the meeting email Melinda@sgsonline.org to update your contact information.

Learning Objectives

At the conclusion of the meeting attendees should be able to:

1. Choose when the laparoscopic or robotic approach is indicated for benign gynecology and consider cost-benefit analysis.
2. Recognize that shared decision making is a necessary part of the informed consent process.
3. Summarize the limited outcome data of recent gynecologic surgery technologies.
4. Apply knowledge of pelvic anatomy to minimize peri-operative complications.

— CME Information —

5. Classify potential ethical issues surrounding elective and cosmetic gynecologic procedures.
6. Identify national gynecologic surgical outcome database and registry initiatives.

ACCREDITATION

Accreditation Statement: This activity has been planned and implemented in accordance with the accreditation requirements and policies of the Accreditation Council for Continuing Medical Education through the joint providership of Oakstone Publishing, LLC and The Society of Gynecologic Surgeons. The Oakstone Publishing, LLC is accredited by the ACCME to provide continuing medical education for physicians.

Designation Statement: Oakstone Publishing, LLC designates this live activity for a maximum of 25.25 *AMA PRA Category 1 Credits™*. Physicians should claim only the credit commensurate with the extent of their participation in the activity.

The 25.25 credits are inclusive of 1) 14.75 credits for Scientific Meeting 2) 1.00 credit for Academic Roundtable 3) 3.75 credit for each Postgraduate Course 4) 1.00 credit for Monday morning Poster Session 5) 1.00 credit for Tuesday morning Poster Session.

Disclosure and Conflicts of Interest

Disclosure: Oakstone Publishing, LLC adheres to ACCME Essential Areas, Standards, and Policies regarding industry support of continuing medical education. Disclosure of the Activity Director(s), Planning Committee Members(s), Speaker(s), Author(s) or Anyone in a Position to Control Content regarding commercial relationships will be made known at the activity. Speakers are required to openly disclose any limitations of data and/or any discussion of off-label, experimental, or investigational uses of drugs or devices in their presentations.

Resolution of Conflicts of Interest

In accordance with ACCME Standards for Commercial Support of CME, Oakstone Publishing, LLC will implement mechanisms, prior to the planning and implementation of this CME activity, to identify and resolve any conflicts of interest for all individuals in a position to control content of this CME activity.

— *Welcome to the New SGS Members* —

Mohamed Akl, MD
Mesa, AZ

Thomas Aigmueller, MD
Graz, Austria

Daniele Antosh, MD
Houston, TX

Megan Billow, DO
Cleveland, OH

Catrina Crisp, MD
Cincinnati, OH

Nicole Donnellan, MD
Pittsburgh, PA

Karolynn Echols, MD
Voorhees, NJ

Mark Ellerkmann, MD
Baltimore, MD

Sean Francis, MD
Louisville, KY

Cara Grimes, MD
New York, NY

Gerald Harkins, MD
Hershey, PA

Hey-Chen Hur, MD
Boston, MA

Peter Jeppson, MD
Albuquerque, NM

Lisa Johnson, MD
Chicago, IL

Cara King, DO
Madison, WI

Janet Li, MD
Boston, MA

Rebecca Margulies, MD
Oakland, CA

Michelle Morrill, MD
San Francisco, CA

Gina Northington, MD, PhD
Atlanta, GA

John Occhino, MD
Rochester, MN

Olga Ramm, MD
Oakland, CA

Monica Richardson, MD
San Jose, CA

Beri Ridgeway, MD
Cleveland, OH

Audrey Romero, MD
West Orange, NJ

Jonathan Shepherd, MD
Pittsburgh, PA

Gary Sutkin, MD
Pittsburgh, PA

Elena Tunitsky-Bitton, MD
Hartford, CT

Stacey Wallach, MD
Sacramento, CA

Terry White, MD
Oakland, CA

— Member Candidate Presentations —

Matthew A. Barker – Videofest 15

**TRANSVAGINAL EXCISION OF ERODED SACROCOLPOPEXY
MESH INTO BLADDER WITH EXTRACELLULAR MATRIX GRAFT
AUGMENTATION**

Kyle Wohlrab – Oral Poster 04

**LONG-TERM SYMPTOMS, QUALITY OF LIFE AND GOAL
ATTAINMENT AFTER SURGERY VERSUS PESSARY FOR PELVIC
ORGAN PROLAPSE.**

Sabrina Wyatt – Non-Oral Poster 40

**EFFECT OF RADIOFREQUENCY ENDOMETRIAL ABLATION ON
DYSMENORRHEA**

**Earn Additional CME Credit by
Coming to the Poster Session/Continental Breakfast**

When: Monday and Tuesday mornings from 6:30 AM – 7:30 AM

Where: The Santa Rosa Patio

Poster presenters will be available by their posters to discuss their research.

Monday – Posters 41-80

Tuesday – Posters 1-40

— Women's Council —

**SGS Women's Council Presents
a Professional Development Program**

***Tips and Tricks from the Trenches: What Every Surgeon
Should Know about Running a Practice***

**Sunday, April 10, 2016
7:30 pm - 9:00 pm – Crystal Ballroom I**

*Surviving Healthcare Transformation:
If You're Not Sitting at the Table, You're on the Menu*

How to Survive Day to Day: Building an Exceptional Team

*Female Sexual Dysfunction and the Gynecologic Surgeon:
No Longer Strange Bedfellows*



Moderated by Cheryl Iglesia, MD

Panelists:



Drew Cassidenti, MD



Rebecca Rogers, MD



Sheryl Kingsberg, PhD

Dessert and Wine will be Served
(All Meeting Participants are Welcome to Attend)
Supported by SGS Professional Development Fund

Featured Speakers

— **TeLinde Lecture** —



Peter Rosenblatt, MD
Director of Urogynecology,
Mount Auburn Hospital
Cambridge, MA

Dr. Peter Rosenblatt received his B.A. from Brown University and his M.D. from Tufts University School of Medicine, in Boston. He completed an internship and residency in Ob/Gyn at University of Massachusetts Medical School and a fellowship in Urogynecology and Pelvic Reconstructive Surgery at Brown University.

Since 1995, Dr. Rosenblatt has been the Director of Urogynecology and Reconstructive Pelvic Surgery at Mount Auburn Hospital, in Cambridge. He served as the Urogynecology Fellowship Director at Mount Auburn Hospital from 1999 - 2010. Dr. Rosenblatt is an Assistant Professor of Ob/Gyn at Harvard Medical School. He is board certified in Ob/Gyn and Female Pelvic Medicine and Reconstructive Surgery. He has an active clinical practice and specializes in laparoscopic reconstructive pelvic surgery and minimally invasive treatments for urinary and fecal incontinence.

Dr. Rosenblatt has authored many original research papers in urogynecology and laparoscopic surgery, serves as an editorial board member for FPMRS and JMIG and is an ad hoc reviewer for many peer reviewed journals in Obstetrics and Gynecology. He has served on the Board of Directors of the American Urogynecologic Society, and has been the video chair of the Society of Gynecologic Surgeons, AUGS, and AAGL. He has invented and licensed technology to several major medical device companies, and holds thirteen patents in the field of urogynecology and general surgery.

***Dr. Rosenblatt will present “Innovation or Experimentation:
Where do we draw the line?” on Tuesday at 10:45 AM.***

— **Keynote Lecture** —



Tina Groat, MD, MBA
Senior Medical Director, Informatics,
OptumInsight Consulting
Canton, MI

Dr. Groat is the Senior Medical Director, Informatics and Consulting for OptumInsight. She received her medical degree from Harvard Medical School in 1997 and her MBA for the University of Michigan in 2008. Dr. Groat did her residency in Obstetrics and

Gynecology at Duke University Medical Center where she served as Assistant Administrative Chief Resident.

After residency she worked as an Assistant Professor of Clinical Ob/Gyn at Indiana University School of Medicine from 2001-2005 and then a Clinical Instructor at the University of Michigan Obstetrics and Gynecology Department from 2005-2006. She joined UnitedHealthcare in 2008 and served as the National Medical Director for Women's Health and Genetics Line of service.

In her role as National Medical Director she worked to promote quality and affordability for both patients and physicians in the areas of Women's Health and Genetics. In 2015, Dr. Groat became a Senior Medical Director in the OptumInsight Consulting Network Analytics practice. She currently works on payment innovation and provider performance measurement.

Dr. Groat will present "Vaginal Hysterectomy and the Transition to Value Based Payment" on Monday at 10:00 AM.

— **Special Guest Lecture** —



Marci Bowers, MD
Burlingame, CA

Marci Bowers, MD of Burlingame, California, is widely recognized as a pioneer in the field of Genital Reassignment Surgery and is the first transgender woman in the world to perform transgender surgery in addition to being the first US surgeon to learn the technique of functional clitoral restoration after female genital mutilation (FGM).

She is a pelvic and gynecologic surgeon with more than 25 years' experience in Women's Healthcare and working with the Transgender community as well as victims of FGM. She is a University of Minnesota Medical School graduate and an Ob/Gyn product of the University of Washington in Seattle. There, she practiced as an Obstetrician/Gynecologist at The Polyclinic and Swedish Medical Center. She parlayed her transgender pelvic reconstructive work to learn functional FGM restoration from Dr. Pierre Foldes in Paris in 2007 and 2009. She relocated her surgical practice to the San Francisco Bay Area in 2010, where she continues to practice.

As an international authority on clitoral reconstruction Dr. Bowers is sought after as a speaker and worldwide surgical educator, and has been featured in numerous documentaries and news features including the Guardian, BBC, Times of London and many others. Dr. Bowers is a member of WPATH, and serves on the board of directors for both GLAAD and the Transgender Law Center. Her transgender work has been highlighted by appearances on Oprah, CBS Sunday Morning and Discovery Health. Dr. Bowers was recently honored as one of the 100 most influential LGBT people on the Guardian's World Pride Power List, in addition to being recognized as one of Huffington Post's 50 Transgender Icons.

Dr. Bowers will present "New Frontiers in Gynecologic Surgery: Transgender Surgery and Functional Clitoroplasty after Female Genital Mutilation" on Tuesday at 12:40 PM.

— **Saturday, April 9 & Sunday, April 10, 2016** —

Saturday

5:00 PM – 7:00 PM **Registration** (*Postgraduate Courses Only*)
Crystal Registration Desk

Sunday, April 10

7:00 AM – 7:00 PM **Registration**
Crystal Registration Desk

Postgraduate Courses

8:00 AM – 12:00 PM **Vaginal Hysterectomy: A to Z**
Crystal Ballroom I
Supported by KARL STORZ Endoscopy-America, Inc

8:00 AM – 12:00 PM **Mastering Pelvic Pain: Strategies and Techniques
for a Multimodal Approach**
Crystal Ballroom H

1:00 PM – 5:00 PM **Laparoscopic Suturing: Breaking through the
Barriers**
Crystal Ballroom AB
*Supported by Applied Medical, Ethicon, KARL
STORZ Endoscopy-America, Inc, and Medtronic*

2:30 PM – 5:00 PM **Making Media Social**
Crystal Ballroom H

4:00 PM – 7:00 PM **Speaker Ready Room/Video Café**
Esmeralda Boardroom

6:00 PM – 7:00 PM **Welcome Reception**
Cascade Landing

7:30 PM – 9:00 PM **Women's Council Presentation**
**Tips and Tricks from the Trenches: What Every
Surgeon Should Know about Running a Practice**
Moderator: Cheryl Iglesia, MD
Panelists: Drs. Andrew Cassidenti, Rebecca Rogers,
and Sheryl Kingsberg
Crystal Ballroom I
Supported by SGS Professional Development Fund

Monday, April 11

***Third Annual SGS Awards Ceremony
Monday night, April 11***

6:45 PM – 7:15 PM

Don't miss out on the Prize Paper awards presentation,
and new awards will also be presented this year.

President's Reception immediately
follows Awards Ceremony.

— **Monday, April 11, 2016** —

- 6:00 AM – 3:00 PM **Registration**
Esmeralda Registration Desk
- 6:30 AM – 6:30 PM **Speaker Ready Room/Video Café**
Esmeralda Boardroom
- 6:30 AM – 7:30 AM **Poster Session with Continental Breakfast**
Santa Rosa Patio
- 7:30 AM – 7:50 AM **Welcome and Recognize New SGS Members**
Esmeralda Ballroom 1-4
- 7:50 AM – 9:15 AM First Scientific Session**
Moderators: Marlene Corton, MD, and Andrew Walter, MD
Esmeralda Ballroom 1-4
- 7:50 AM **Oral Presentation 01**
**REASONS FOR UNPLANNED 30-DAY READMISSION
AFTER HYSTERECTOMY FOR BENIGN DISEASE**
C. Penn¹; D. M. Morgan¹; J. Rauh-Hain²; L. W. Rice³; S. Uppal¹
¹University of Michigan , Ann Arbor, MI, ²Massachusetts General Hospital, Boston, MA, ³University of Wisconsin, Madison, WI

DISCUSSANT: Brittany Star Hampton, MD
- 8:05 AM **Oral Presentation 02**
**A COMPARISON OF VAGINAL AND ROBOTIC
HYSTERECTOMY FOR COMMONLY CITED RELATIVE
CONTRAINDICATIONS TO VAGINAL
HYSTERECTOMY**
J. Schmitt¹; D. Carranza¹; J. A. Occhino¹; M. McGree²; A. Weaver²; J. Gebhart¹
¹Gynecologic Surgery, Mayo Clinic, Rochester, MN, ²Biomedical Statistics and Informatics, Mayo Clinic, Rochester, MN

DISCUSSANT: Catherine Matthews, MD
- 8:20 AM **Oral Poster 01**
**ADDITION OF PUDENDAL BLOCKS TO PELVIC
FLOOR PHYSICAL THERAPY FOR THE TREATMENT
OF PELVIC PAIN: A RANDOMIZED, PLACEBO
CONTROLLED TRIAL**
F. L. Lane¹; K. Noblett^{2,1}; D. Markle-Price¹; K. Osann¹

— **Monday, April 11, 2016** —

¹Obstetrics and Gynecology, University of California Irvine, Orange, CA, ²Obstetrics and Gynecology, University of California Riverside, Riverside, CA

8:24 AM

Oral Poster 02

THE EFFECT OF PREOPERATIVE FUNCTIONAL STATUS AND CAPACITY ON THE INCIDENCE OF PERIOPERATIVE ADVERSE EVENTS IN THE SUPER-ELDERLY UNDERGOING UROGYNECOLOGIC SURGERY

L. Hickman; C. A. Unger; B. E. Mitchell-Handley; M. D. Barber; B. Ridgeway
Ob/Gyn & Women's Health Institute, Cleveland Clinic, Cleveland, OH

8:28 AM

Oral Poster 03

PELVIC FLOOR MUSCLE MOTOR UNIT RECRUITMENT: KEGELS VS SPECIALIZED MOVEMENT

B. S. Crawford
Center for Pelvic Floor Medicine, Reno, NV

8:32 AM

Oral Posters Q&A

8:35 AM

Oral Presentation 03

EFFECT OF DIFFERENT CHAIRS ON WORK-RELATED MUSCULOSKELETAL DISCOMFORT DURING VAGINAL SURGERY

R. Singh⁴; D. Carranza⁴; M. M. Morrow²; T. L. Vosdraper⁵; M. McGree³; A. Weaver³; S. M. Woolley¹; S. Hallbeck²; J. Gebhart⁴

¹Department of Occupational safety, Mayo Clinic, Rochester, MN, ²Department of Health Care Systems Engineering, Mayo Clinic, Rochester, MN, ³Division of Biomedical Statistics and Informatics, Mayo Clinic, Rochester, MN, ⁴Department of Obstetrics and Gynecology, Mayo Clinic, Rochester, MN, ⁵Department of Physical Medicine and Rehabilitation, Mayo Clinic, Rochester, MN

DISCUSSANT: Andrew Cassidenti, MD

— **Monday, April 11, 2016** —

- 8:50 AM **Oral Presentation 04**
**PATIENT-REPORTED FUNCTIONING OUTCOMES
AFTER SURGERY COMPARED TO PESSARY FOR
THE TREATMENT OF PELVIC ORGAN PROLAPSE
USING THE PATIENT REPORTED OUTCOMES
MEASUREMENT SYSTEM**
A. M. Madsen; C. A. Raker; V. Sung
Urogynecology/Obstetrics and Gynecology, Women and
Infants Hospital/Warren Alpert Medical School of Brown
University, Providence, RI

DISCUSSANT: Andrew Sokol, MD
- 9:05 AM **Video Presentation 01**
**ANATOMIC AND VASCULAR CONSIDERATIONS IN
LAPAROSCOPIC UTERINE ARTERY LIGATION
DURING HYSTERECTOMY**
A. Peters; M. Stuparich; S. Mansuria; T. Lee
Obstetrics, Gynecology and Reproductive Sciences,
Magee Womens Hospital of UPMC, Pittsburgh, PA
- 9:15 AM - 9:45 AM Refreshments/Exhibits/View Posters**
Exhibit Hall -- Esmeralda Ballroom 5-8
- 9:45 AM - 11:35 AM Second Scientific Session**
Moderators: Cara Grimes, MD and
Holly Richter, PhD, MD
Esmeralda Ballroom 1-4
- 9:45 AM **Oral Presentation 05**
**MINDFULNESS-BASED STRESS REDUCTION AS A
NOVEL TREATMENT FOR INTERSTITIAL
CYSTITIS/BLADDER PAIN SYNDROME: A
RANDOMIZED CONTROLLED TRIAL**
G. Kanter; Y. Komesu; F. Qaedan; R. Rogers
University of New Mexico, Albuquerque, NM

DISCUSSANT: Elisabeth Erekson, MD
- 10:00 AM **KEYNOTE LECTURE**
**"Vaginal Hysterectomy and the Transition to Value
Based Payment"**
Tina Groat, MD, MBA
Introduction by Andrew Walter, MD

— **Monday, April 11, 2016** —

- 10:40 AM **Oral Presentation 06**
COMPARISON OF ROBOTIC AND OTHER MINIMALLY-INVASIVE ROUTES OF HYSTERECTOMY FOR BENIGN INDICATIONS
C. W. Swenson; N. S. Kamdar; D. M. Morgan
University of Michigan, Ann Arbor, MI
- DISCUSSANT:** Ted Lee, MD
- 10:55 AM **Oral Presentation 07**
RANDOMIZED CLINICAL TRIAL OF POSTOPERATIVE BELLADONNA AND OPIUM (B&O) SUPPOSITORIES IN VAGINAL SURGERY
K. A. Butler¹; J. Yi¹; J. Klauschie¹; D. L. Ryan²; J. G. Hentz²; J. L. Cornella¹; P. Magtibay¹; R. Kho³
¹Gynecology, Mayo Clinic Arizona, Phoenix, AZ, ²Clinical Studies, Mayo Clinic Arizona, Phoenix, AZ, ³Columbia University Medical Center, New York, NY
- DISCUSSANT:** Douglass Hale, MD
- 11:10 AM **Video Presentation 02**
MODIFIED BEEF TONGUE MODEL FOR FOURTH-DEGREE LACERATION REPAIR SIMULATION
J. D. Illston; A. C. Ballard; D. Ellington; I. Meyer; H. E. Richter
Obstetrics and Gynecology, University of Alabama at Birmingham, Birmingham, AL
- 11:20 AM **Oral Poster 04****
LONG-TERM SYMPTOMS, QUALITY OF LIFE AND GOAL ATTAINMENT AFTER SURGERY VERSUS PESSARY FOR PELVIC ORGAN PROLAPSE.
K. Wohlrab; C. A. Raker; V. Sung
Obstetrics & Gynecology, Women & Infants Hospital / Brown University, Providence, RI
**Member Candidate Presentation
- 11:24 AM **Oral Poster 05**
THE LOW RISK OF CONCOMITANT ADNEXAL SURGERY
M. Abernethy^{1,2}; B. L. Vieira³; J. Y. Kim³; K. E. Drury³; K. Kenton¹
¹Division of Female Pelvic Medicine and Reconstructive

— **Monday, April 11, 2016** —

Surgery, Feinberg School of Medicine, Northwestern University, Chicago, IL, ²Division of Female Pelvic Medicine and Reconstructive Surgery, Johns Hopkins, Baltimore, MD, ³Department of Surgery, Feinberg School of Medicine, Northwestern University, Chicago, IL

- 11:28 AM **Oral Poster 06**
NATIONAL ASSESSMENT OF ADVANCING AGE ON PERIOPERATIVE MORBIDITY AND LENGTH OF STAY ASSOCIATED WITH MINIMALLY INVASIVE SACROCOLPOPEXY
Z. Chaudhry¹; S. Cohen²; C. Tarnay^{1,2}
¹Department of Obstetrics and Gynecology, UCLA David Geffen School of Medicine, Los Angeles, CA, ²Department of Urology, UCLA David Geffen School of Medicine, Los Angeles, CA
- 11:32 AM **Oral Posters Q & A**
- 11:35 AM - 12:35 PM Lunch/Exhibits/Review Posters**
Exhibit Hall -- Esmeralda Ballroom 5-8
- 12:35 PM - 2:20 PM Third Scientific Session**
Moderators: R. Edward Varner, MD, and Blair Washington, MD
Esmeralda Ballroom 1-4
- 12:35 PM **Video Presentation 03**
CONTAINED VAGINAL TISSUE EXTRACTION FOR THE MINIMALLY INVASIVE SURGEON
K. Simpson; S. Madueke Laveaux; R. Kho; A. P. Advincula
OB/GYN, Columbia University Medical Center, New York, NY
- 12:45 PM ***DEBATE: Surgeons as Innovators - What is the Patient Expecting?***
Moderator: Charles Rardin, MD
PRO: Christine LaSala, MD, and Dennis Miller, MD vs
CON: Peggy Norton, MD, and Jim Whiteside, MD
- 1:20 PM **Oral Poster 07**
RECURRENT URINARY TRACT INFECTION AFTER MID-URETHRAL SLING

— **Monday, April 11, 2016** —

C. Russman²; S. Moore²; C. Pugh, DO²; J. Long²; C. Chen¹

¹Johns Hopkins, Baltimore, MD, ²Reading Hospital, Reading, PA

1:24 PM

Oral Poster 08

ESTIMATION OF UTERINE SIZE: HOW ACCURATE ARE WE?

T. P. Hoke¹; B. Vakili²

¹Obstetrics and Gynecology, Christiana Care Health System, Newark, DE, ²Center for Urogynecology and Pelvic Surgery, Christiana Care Health System, Newark, DE

1:28 PM

Oral Poster 09

DECREASING LENGTH OF STAY FOR VAGINAL HYSTERECTOMY THROUGH QUALITY IMPROVEMENT CYCLE

C. E. Foust-Wright; M. Wakamatsu; A. Johnson; M. Weinstein; S. J. Pulliam

Obstetrics and Gynecology, Massachusetts General Hospital, Framingham, MA

1:32 PM

Oral Posters Q & A

1:35 PM

SRG Update – Miles Murphy, MD

1:55 PM

Video Presentation 04

USE OF METHYLENE BLUE FOR DETECTION OF SENTINEL LYMPH NODES IN CERVICAL CANCER

G. Menderes; C. deHaydu; C. L. Schwab; J. Black; M. Azodi

Obstetrics, Gynecology and Reproductive Sciences, Yale University School of Medicine, West Haven, CT

2:05 PM

Oral Poster 10

RETROPUBIC AND SACROSPINOUS ANATOMY USING 3 DIMENSIONAL IMAGING

O. F. Duenas; Y. Kim; K. Leung; M. K. Flynn

Obstetrics and Gynecology, University of Massachusetts, Holden, MA

2:09 PM

Oral Poster 11

ENHANCED RECOVERY SAFETY IN OUTPATIENT HYSTERECTOMY

M. Wasson; K. A. Butler

Gynecologic Surgery, Mayo Clinic Arizona, Phoenix, AZ

— **Monday, April 11, 2016** —

- 2:13 PM **Oral Poster 12**
**PREVALENCE OF UROGYNECOLOGIC DIAGNOSES
IN WOMEN IRRADIATED FOR PELVIC CANCER**
S. Dutta; F. L. Lane
Obstetrics and Gynecology, University of California,
Irvine, Manhattan Beach, CA
- 2:17 PM **Oral Posters Q & A**
- 2:20 PM **Adjourn**
- 2:25 PM-4:30 PM** **Videofest**
Moderators: Rajiv Gala, MD, and Michael Moen, MD
Esmeralda Ballroom 1-4
- 2:25 PM **Videofest 11**
NATURAL ORIFICE SACROHYSTEROPEXY
A. Martinez ^{1,2}
¹Obstetrics and Gynecologic Services, Hospital Regional
Monterrey ISSSTE, Monterrey Nuevo Leon, Nuevo Leon,
Mexico, ²professor, Universidad Autonoma de Nuevo
Leon, Monterrey, Nuevo Leon, Mexico
- 2:32 PM **Videofest 12**
**ROBOTICALLY ASSISTED RESECTION OF
PERICARDIAL ENDOMETRIOSIS**
M. Wasson; J. F. Magrina; P. Magtibay
Gynecologic Surgery, Mayo Clinic Arizona, Phoenix, AZ
- 2:39 PM **Videofest 13**
**COMPLETE COLPECTOMY AND COLPOCLEISIS: A
MODEL FOR SIMULATION**
A. Petrikovets¹; J. Himler²; J. W. Henderson¹; R. James¹;
R. R. Pollard²; J. Mangel²; S. T. Mahajan¹
¹Female Pelvic Medicine & Reconstructive Surgery,
University Hospitals Case Medical Center, Cleveland,
OH, ²Urogynecology & Reconstructive Pelvic Surgery,
MetroHealth Medical Center, Cleveland, OH
- 2:46 PM **Videofest Q & A**

— **Monday, April 11, 2016** —

- 2:51 PM **Videofest 14**
**ROBOTIC-ASSISTED LAPAROSCOPIC REMOVAL OF
ERODED TRANSOBTURATOR MIDURETHRAL SLING
AFTER FAILED CYSTOSCOPIC EXCISION**
K. Schwirian¹; C. Bowling²
¹Obstetrics and Gynecology, University of Tennessee
Medical Center, Knoxville, TN, ²Urogynecology,
University of Tennessee Medical Center, Knoxville, TN
- 2:58 PM **Videofest 15****
**TRANSVAGINAL EXCISION OF ERODED
SACROCOLPOPEXY MESH INTO BLADDER WITH
EXTRACELLULAR MATRIX GRAFT AUGMENTATION**
M. A. Barker^{1,2}
¹Obstetrics & Gynecology, The University of South
Dakota, Sioux Falls, SD, ²Urogynecology, Avera
McKenna Hospital & University Center, Sioux Falls, SD
**Member Candidate Presentation
- 3:05 PM **Videofest 16**
TIPS AND TRICKS FOR OPEN LAPAROSCOPY
K. R. Smithling¹; C. Iglesia^{1,2}
¹OB/GYN, Division of Female Pelvic Medicine and
Reconstruction Surgery, MedStar Washington Hospital
Center, Washington, , ²OB/GYN and Urology,
Georgetown University School of Medicine, Washington
- 3:10 PM **Videofest Q & A**
- 3:15 PM **Videofest 17**
**ROBOTICALLY ASSISTED RESECTION OF
ENDOMETRIOSIS INVOLVING THE BLADDER**
M. Wasson; J. F. Magrina; P. Magtibay
Gynecologic Surgery, Mayo Clinic Arizona, Phoenix, AZ
- 3:22 PM **Videofest 18**
**UTILITY OF MRI IN DEEPLY INFILTRATING
ENDOMETRIOSIS**
D. Lum
Ob/gyn, Stanford University, Stanford, CA

— **Monday, April 11, 2016** —

- 3:29 PM **Videofest 19**
MANAGEMENT OF POSTERIOR VAGINAL WALL MESH COMPLICATIONS
S. Hussain^{1,2}; M. Karram¹
¹CHRIST HOSPITAL, Cincinnati, OH, ²University of Cincinnati, Cincinnati, OH
- 3:35 PM **Videofest Q & A**
- 3:40 PM **Videofest 20**
ROBOT-ASSISTED LAPAROSCOPIC REMOVAL OF RUDIMENTARY UTERINE HORN
T. Baker^{1,2}; a. steren²; E. G. Lockrow^{1,3}
¹Minimally Invasive Gynecology Surgery Department, Walter Reed National Military Medical Center, Silver Spring, MD, ²Gynecology Oncology, Holy Cross Hospital, Silver Spring, MD, ³OBGYN, Uniformed Services University of Health Sciences, Bethesda, MD
- 3:47 PM **Videofest 21**
LAPAROSCOPIC RADICAL HYSTERECTOMY FOR STAGE IIA1 CERVICAL CANCER
A. Mandelberger; V. Andikyan; V. Kolev
Obstetrics and Gynecology, Icahn School of Medicine at Mount Sinai, New York, NY
- 3:54 PM **Videofest 22**
STRATEGIES FOR PROPHYLACTIC OOPHORECTOMY
J. Casey; A. Yunker
Obstetrics and Gynecology, Vanderbilt Medical Center, Nashville, TN
- 3:59 PM **Videofest Q & A**
- 4:04 PM **Videofest 23**
A PERPLEXING VAGINAL MASS: PROLAPSED UTERUS OR FIBROID, OR BOTH?
B. W. Newton; O. Harmanli
Obstetrics and Gynecology, Tufts University School of Medicine Baystate Medical Center, Springfield, MA

— **Monday, April 11, 2016** —

- 4:11 PM **Videofest 24**
NOVEL CLASSIFICATION OF LABIA ANATOMY IN THE EVALUATION AND TREATMENT OF VAGINAL AGGLUTINATION
M. L. Nieto^{1,2}; T. Brueseke^{1,2}; C. Wu³; E. Geller^{1,2}; D. Zolnoun^{1,2,3}
¹Urogynecology, UNC, Chapel Hill, NC, ²Obstetrics & Gynecology, UNC, Chapel Hill, NC, ³Plastic Surgery, UNC, Chapel Hill, NC
- 4:18 PM **Videofest 25**
CASE REPORT: APPROACH TO LAPAROSCOPIC HYSTERECTOMY IN A WOMEN WITH A 30 CENTIMETER POSTERIOR FIBROID
M. V. Vargas¹; S. Margulies²; J. Robinson³
¹Division of Gynecology, George Washington University Medical Center, Washington, ²School of Medicine and Health Sciences, George Washington University Medical Center, Washington, , ³Division of Minimally Invasive Gynecologic Surgery, MedStar Washington Hospital Center, Washington
- 4:25 PM **Videofest Q & A**
- 2:30 PM – 6:30 PM **FPRN® Meeting**
AUGS-SGS Subgroup
Crystal Ballroom AB
- 5:45 PM – 6:30 PM **FMIGS-SGS Subgroup**
Crystal Ballroom AB
- 5:30 PM – 6:30 PM **FMIGS-SGS Subgroup**
Crystal Ballroom H
- 5:30 PM – 6:30 PM **Academic Rounds With the Experts**
Mountain View
Enjoy California Wine and Cheese at the Informal "Rounds with the Experts"
1. Laparoscopic Entry Techniques: What's New and What's Best? – William Hurd, MD
 2. Approach to the Difficult Laparoscopic Hysterectomy – Deirdre Lum, MD
 3. How you Generate Revenue. Understanding RVU's and Income – Mitchell Schuster, MD

— **Monday, April 11, 2016** —

4. Reviewing a Paper - Tips and Tricks From the Editor-in-Chief – Paul Riss, MD
5. Transgender for the Gynecologist – Marci Bowers, MD
6. Advanced Surgical Procedures Utilizing Minimally Invasive Robotic Technology: Less Commonly Performed Procedures by Gynecologic Surgeons – Paul Magtibay, MD
7. The Role of Uterine Conservation in Women with Uterovaginal Prolapse – Beri Ridgeway, MD
8. Diagnosing and Managing Mullerian Anomalies – Claire Templeman, MD
9. A Hitchhikers Guide to the Retroperitoneum – Nicole Donnellan, MD
10. Fecal Incontinence Treatments - Tried and True versus Brand New – Gena Dunivan, MD
11. Scientific Rationale for Vaginal Hysterectomy and Native Tissue Repairs for Primary Prolapse Surgery– Michael Moen, MD
12. Combined Medical Surgical Approaches Can Optimize Management of CPP – Frank Tu, MD and Paul Pettit, MD

6:45 PM – 7:15 PM Awards Ceremony
Esmeralda Ballroom 1-4

7:15 PM – 8:30 PM President's Reception
Esmeralda Ballroom 5-8



Evening with the Stars!

**Tuesday, April 12, 2016
7:00 PM - 9:30 PM**

Stir Lounge

SHARE a good time, cocktails and some hors d'oeuvres to support the SGS mission.

A portion of each ticket sold to this event will go toward the SGS Mission to Advance Research and Education.

Golf Tournament Winners and Mountain Biking Awards will be announced during the reception.

*Tickets still available
at the SGS Registration Desk.*

Tuesday, April 12

— **Tuesday, April 12, 2016** —

6:00 AM – 1:30 PM	Registration <i>Esmeralda Registration Desk</i>
6:30 AM – 6:00 PM	Speaker Ready Room/Video Café <i>Esmeralda Ballroom</i>
6:30 AM – 7:30 AM	Poster Session with Continental Breakfast <i>Santa Rosa Patio</i>
7:30	Announcements
7:35 AM – 9:20 AM	Fourth Scientific Session Moderators: Nicole Donnellan, MD, and Cheryl Iglesia, MD <i>Esmeralda Ballroom 1-4</i>
7:35 AM	Oral Presentation 08 INFERIOR GLUTEAL NEUROVASCULAR ANATOMY IN FEMALE CADAVERS: CLINICAL APPLICATIONS TO PELVIC RECONSTRUCTIVE SURGERIES <u>M. E. Florian-Rodriguez</u> ; A. Hare; J. Phelan; K. Chin; C. Ripperda; M. Corton UT Southwestern Medical Center, Dallas, TX DISCUSSANT: Matthew Barber, MD
7:50 AM	Oral Presentation 09 THE WASTED VAGINAL HYSTERECTOMY—AN ARGUMENT FOR TRACKING IN OBSTETRICS AND GYNECOLOGY RESIDENCY PROGRAMS <u>B. Dave</u> ; A. Leader-Cramer; K. Bochenska; A. Alverdy; M. G. Mueller; C. Lewicky-Gaupp; K. Kenton Division of Female Pelvic Medicine and Reconstructive Surgery, Northwestern University, Chicago, IL DISCUSSANT: C. Bryce Bowling, MD
8:05 AM	Oral Poster 13 VALIDATION OF AN EDUCATIONAL SIMULATION MODEL FOR VAGINAL HYSTERECTOMY (VH) TRAINING. DESIGN: PROSPECTIVE COHORT STUDY <u>D. Miyazaki</u> ¹ ; C. Mathews ² ; A. Sherif El Haraki ³ ¹ OB/GYN, WomanCare, Novant Health, Wake Forest University, Winston Salem, NC, ² Urology/ OB/GYN,

— **Tuesday, April 12, 2016** —

Wake Forest, Winston Salem, NC, ³OB/GYN, Wake Forest University, Winston Salem, NC

8:09 AM

Oral Poster 14
USEFULNESS OF PHENAZOPYRIDINE IN
INTRAOPERATIVE CYSTOSCOPY

K. Propst¹; D. M. O'Sullivan²; C. LaSala¹; E. Tunitsky¹
¹Urogynecology, Hartford Hospital, Hartford, CT, ²Research Administration, Hartford Hospital, Hartford, CT

8:13 AM

Oral Poster 15
THE EFFECT OF SURGERY ON SEXUAL FUNCTION
IN WOMEN WITH SUSPECTED GYNECOLOGIC
MALIGNANCIES

C. E. Bretschneider¹; J. T. Bensen²; E. J. Geller¹; P. A. Gehrig¹; J. M. Wu^{1,3}; K. Doll¹
¹Ob/Gyn, University of North Carolina, Carrboro, NC, ²Epidemiology, University of North Carolina, Chapel Hill, Chapel Hill, NC, ³Center for Women's Health Research, University of North Carolina, Chapel Hill, Chapel Hill, NC

8:17 AM

Oral Posters Q & A

8:20 AM

Oral Presentation 10
DETERMINING THE OPTIMAL ROUTE OF
HYSTERECTOMY FOR BENIGN INDICATIONS: A
CLINICAL DECISION TREE ALGORITHM

J. Schmitt¹; D. Carranza¹; A. Weaver²; J. A. Occhino¹; S. Dowdy¹; J. Bakkum-Gamez¹; K. Pasupathy²; J. Gebhart¹
¹Gynecologic Surgery, Mayo Clinic, Rochester, MN, ²Mayo Clinic, Rochester, MN.

DISCUSSANT: Christina Lewicky-Gaupp, MD

8:35 AM

PRESIDENTIAL ADDRESS

Andrew Walter, MD
Introduction by Holly Richter, PhD, MD

— **Tuesday, April 12, 2016** —

- 9:10 AM **Video Presentation 05**
**SALPINGO-OOPHORECTOMY BY TRANSVAGINAL
NATURAL ORIFICE TRANSLUMINAL ENDOSCOPIC
SURGERY**
K. Jallad; L. N. Siff; T. Thomas; M. R. Paraiso
Cleveland Clinic, Cleveland, OH
- 9:20 AM – 9:50 AM **Refreshments/Exhibits/View Posters**
Exhibit Hall -- Esmeralda Ballroom 5-8
- 9:50 AM – 11:30 AM **Fifth Scientific Session**
Moderators: Danielle Antosh, MD, and
Mikio Nihira, MD
Esmeralda Ballroom 1-4
- 9:50 AM **Video Presentation 06**
NATURAL ORIFICE SACRAL COLPOPEXY
C. R. Hanes
Urogynecology of Southern Alabama, Mobile, AL
- 10:00 AM **Oral Presentation 11**
**IMPACT OF SURGICAL TRAINING ON
PERFORMANCE OF PROPOSED QUALITY
MEASURES FOR HYSTERECTOMY FOR PELVIC
ORGAN PROLAPSE**
E. Adams-Piper¹; N. Guaderrama²; E. Whitcomb²
¹Ob/Gyn, Division of Urogynecology, University of
California, Irvine, Orange, CA, ²Ob/Gyn, Division of
Urogynecology, Southern California Permanente Medical
Group, Irvine Medical Center, Irvine, CA
- DISCUSSANT:** Tyler Muffly, MD
- 10:15 AM **Oral Presentation 12**
**COSTS ASSOCIATED WITH INSTRUMENT
STERILIZATION IN GYNECOLOGIC SURGERY**
M. M. Van Meter; R. Adam
Obstetrics and Gynecology, Vanderbilt University
Medical Center, Nashville , TN
- DISCUSSANT:** Dobie Giles, MD

— **Tuesday, April 12, 2016** —

- 10:30 AM **Oral Poster 16**
CHARACTERIZATION AND PREOPERATIVE RISK STRATIFICATION OF LEIOMYOSARCOMA AT A HIGH-VOLUME TERTIARY CARE CENTER
A. Peters¹; A. M. Sadecky^{1,2}; D. Winger³; R. Guido¹; T. Lee¹; S. Mansuria¹; N. M. Donnellan¹
¹Obstetrics, Gynecology and Reproductive Sciences, Magee Womens Hospital of UPMC, Pittsburgh, PA, ²Obstetrics and Gynecology, Oregon Health & Science University, Portland, OR, ³Clinical and Translational Science Institute, University of Pittsburgh, Pittsburgh, PA
- 10:34 AM **Oral Poster 17**
INAPPROPRIATE USE OF PROPHYLACTIC ANTIBIOTICS IN GYNECOLOGIC SURGERY AT AN ACADEMIC TERTIARY MEDICAL CENTER
K. M. Kremer¹; K. J. Hyde¹; J. S. Joyce^{1,2}; E. Z. Drobnis¹; R. T. Foster¹; L. Brennaman¹
¹Obstetrics, Gynecology, and Women's Health, University of Missouri, Columbia, MO, ²Obstetrics and Gynecology, Scott & White Hospital, Temple, TX
- 10:38 AM **Oral Poster 18**
INCONTINENCE RATES AFTER MIDURTHRAL SLING REVISION FOR VAGINAL EXPOSURE OR PAIN
L. H. Jambusaria¹; J. Heft¹; D. Montagnino¹; W. S. Reynolds²; R. R. Dmochowski²; D. H. Biller¹
¹Obstetrics & Gynecology, Vanderbilt University, Nashville, TN, ²Urologic Surgery, Vanderbilt University, Nashville, TN
- 10:42 AM **Oral Posters Q & A**
- 10:45 AM **TELINDE LECTURE**
"Innovation or Experimentation: Where do we draw the line?"
Peter Rosenblatt, MD,
Director of Urogynecology at Mount Auburn Hospital
Introduction by Eric Sokol, MD

— **Tuesday, April 12, 2016** —

- 11:30 AM – 12:30 PM Lunch/Exhibits/View Posters**
Exhibit Hall -- Esmeralda Ballroom 5-8
Note: *Exhibit Hall closes today at 1:00 PM*
- 12:30 PM – 1:10 PM Sixth Scientific Session**
Moderator: Eric Sokol, MD
Esmeralda Ballroom 1-4
- 12:30 PM **Video Presentation 07**
SURGICAL ANATOMY AND STEPS OF THE
UTEROSACRAL LIGAMENT COLPOPEXY
L. N. Siff; K. Jallad; L. Hickman; M. D. Walters
Urogynecology, Cleveland Clinic Foundation, Cleveland,
OH
- 12:40 PM **Special Lecture: “New Frontiers in Gynecologic**
Surgery: Transgender Surgery and Functional
Clitoroplasty after Female Genital Mutilation”
Marci Bowers, MD, *Pelvic and Gynecologic Surgeon,*
Burlingame, CA
Introduction by Eric Sokol, MD
- 1:10 PM **Adjourn**
- 1:10 PM – 1:30 PM SGS Business Meeting**
Esmeralda Ballroom 1-4
- 1:45 PM – 6:45 PM Mountain Biking**
Meet at Front Entrance by the flagpole
- 2:00 PM – 6:45 PM Golf Tournament**
Indian Wells Golf Course - Celebrity
- 7:00 PM – 9:30 PM Evening with the Stars (Ticketed Event)**
Stir Lounge

— 2015 SGS Scientific Program Award Winners —



Prize Paper – Member/Guest

Critical Anatomy in Relation to the Sacral Suture; A Postoperative Imaging Study Following Robotic Sacrocolpopexy

Catrina C. Crisp, MD, MSc



1st Prize Fellow/Resident

To Pack Or Not To Pack? A Randomized Trial of Vaginal Packing Following Pelvic Reconstructive Surgery

Lauren B. Westermann, DO



2nd Prize Fellow/Resident

Proximity of Uterosacral Ligament Suspension Sutures and Sacral Nerve Roots to Pelvic Anatomic Landmarks

Pedro A. Maldonado, MD



Video Prize

Laparoscopic Ureterolysis: Techniques and Approaches to Ureter Identification and Dissection

Cara R. King, DO, MS



2015 Winning Spirit Award

2nd year FPMRS Fellow

Nominated by an SGS Member

Supported by Boston Scientific

Benjamin Barenberg, MD



2015 AJOG/SGS Impact Award

Obstetrical and Sphincter Laceration and Anal Incontinence 5-10 Years After Childbirth

Emily Evers, Joan Blomquist, Kelly McDermott, Victoria Handa

Wednesday, April 13

— **Wednesday, April 13, 2016** —

- 6:00 AM – 12:00 PM Registration**
Esmeralda Registration Desk
- 6:30 AM – 7:30 AM Continental Breakfast**
Santa Rosa Patio
- 6:30 AM – 12:00 PM Speaker Ready Room/Video Café**
Esmeralda Boardroom
- 7:30 AM Announcements**
- 7:35 AM – 9:30 AM Seventh Scientific Session**
Moderators: Karolynn Echols, MD, and Amy O'Boyle, MD
Esmeralda Ballroom 1-4
- 7:35 AM Oral Presentation 13**
**GENETIC DETERMINANTS OF PELVIC ORGAN
PROLAPSE IN WOMEN OF EUROPEAN AMERICAN
DESCENT: THE WOMEN'S HEALTH INITIATIVE**
A. J. Park^{1,2}; M. Graff ³; A. Giri⁴; J. M. Wu⁵; R. M. Ward⁶;
T. L. Edwards⁷; D. Velez Edwards^{6,7}; B. V. Howard⁸; N.
M. Shara⁸; C. L. Avery³; K. E. North³
¹Department of Obstetrics & Gynecology, MedStar
Washington Hospital Center, Washington, , ²Departments
of Obstetrics & Gynecology, Urology, Georgetown
University School of Medicine, Washington,
, ³Department of Epidemiology, University of North
Carolina, Chapel Hill, NC, ⁴Institute of Medicine and
Public Health, Vanderbilt University, Nashville,
TN, ⁵Department of Obstetrics & Gynecology, University
of North Carolina, Chapel Hill, NC, ⁶Department of
Obstetrics & Gynecology, Vanderbilt University Medical
Center, Nashville, TN, ⁷Vanderbilt Genetics Institute,
Vanderbilt University, Nashville, TN, ⁸MedStar Health
Research Institute, Hyattsville, MD
- DISCUSSANT:** Lennox Hoyte, MD
- 7:50 AM Oral Presentation 14**
**PERIOPERATIVE BUNDLES AND TIMELY
FEEDBACK FOR SURGICAL SITE INFECTION
PREVENTION IN HYSTERECTOMY: AN
INSTITUTIONAL EXPERIENCE**

S. E. Andiman¹; V. Desai¹; M. N. Whitbread²; H. Rillstone⁴; J. M. Boyce³; L. Fan¹

¹Obstetrics, Gynecology and Reproductive Sciences, Yale New Haven Hospital/ Yale School of Medicine, New Haven, CT, ²Infection Prevention, Yale New Haven Hospital, New Haven, CT, ³Hospital Epidemiology and Infection Control, Yale New Haven Hospital, New Haven, CT, ⁴Perioperative Services, Yale New Haven Hospital, New Haven, CT

DISCUSSANT: Jeffrey L. Cornella, MD

8:05 AM

Oral Presentation 15

CHLORHEXIDINE-ALCOHOL COMPARED WITH POVIDONE-IODINE FOR SURGICAL-SITE ANTISEPSIS AFTER ABDOMINAL HYSTERECTOMY

A. Bazzi¹; J. Harris²; D. Morgan²; M. D. Pearlman²; R. Reynolds¹; D. A. Campbell³; S. Uppal³

¹Obstetrics and Gynecology Division of Gynecologic Oncology, University of Michigan, Ann Arbor, MI, ²Obstetrics and Gynecology, University of Michigan, Ann Arbor, MI, ³Surgery, University of Michigan, Ann Arbor, MI

DISCUSSANT: Kristen Matteson, MD

8:20 AM

Oral Poster 19

PREDICTORS OF EARLY POSTOPERATIVE VOIDING DYSFUNCTION AND OTHER COMPLICATIONS FOLLOWING A MIDURETHRAL SLING

C. Ripperda¹; J. Kowalski³; Z. Chaudhry⁷; A. S. Mahal⁴; J. Lanzer⁶; L. Hynan⁶; P. C. Jeppson²; D. D. Rahn¹

¹Obstetrics and Gynecology, University of Texas Southwestern Medical Center, Dallas, TX, ²University of New Mexico, Albuquerque, NM, ³Obstetrics and Gynecology, University of Iowa, Iowa City, IA, ⁴Obstetrics and Gynecology, Stanford University, Palo Alto, CA, ⁵Department of Gynecology and Obstetrics, Emory University, Atlanta, GA, ⁶Department of Clinical Sciences - Division of Biostatistics, University of Texas Southwestern Medical Center, Dallas, TX, ⁷Obstetrics and Gynecology, University of California, Los Angeles, Los Angeles, CA

— **Wednesday, April 13, 2016** —

- 8:24 AM **Oral Poster 20**
**LAPAROSCOPIC SUPRACERVICAL
HYSTERECTOMY (LSH) WITH
SACROCERVICOPEXY: THE USE OF POSTERIOR
COLPOTOMY FOR UTERINE REMOVAL**
N. Noor^{1,2,3}; E. Von Barga^{1,2,3}; H. Warda^{1,2,3}; P. L.
Rosenblatt^{1,2}
¹Urogynecology, Mount Auburn Hospital, Cambridge,
MA, ²Obstetrics and Gynecology, Harvard Medical
School, Cambridge, MA, ³Obstetrics and Gynecology,
Beth Israel Deaconess Medical Center, Boston, MA
- 8:28 AM **Oral Poster 21**
**POOR NATIONWIDE UTILIZATION OF MINIMALLY
INVASIVE SURGERY IN EARLY-STAGE UTERINE
CANCER:
AN HCUP-NATIONAL INPATIENT SAMPLE
DATABASE STUDY**
D. B. Mannschreck¹; S. Dowdy²; E. Tanner³; R. Stone³;
A. Fader³
¹Johns Hopkins School of Medicine, Baltimore,
MD, ²Obstetrics and Gynecology, Mayo Clinic,
Rochester, MN, ³Gynecology and Obstetrics, Johns
Hopkins Hospital, Baltimore, MD
- 8:32 AM **Oral Posters Q & A**
- 8:35 AM **Oral Presentation 16**
**THE SUNSHINE ACT: SHEDDING LIGHT ON THE
INACCURACY OF FINANCIAL DISCLOSURES**
J. Thompson¹; K. Volpe¹; L. Bridgewater¹; F. Qaedan^{1,2};
G. Dunivan¹; Y. Komesu¹; S. Cichowski¹; P. C. Jeppson¹;
R. Rogers¹
¹Urogynecology Department, University of New Mexico,
Albuquerque, NM, ²Biostatistics, Clinical and
Translational Science Center, Albuquerque, NM
- DISCUSSANT:** Megan Schimpf, MD
- 8:50 AM **FPRN® EDUCATION UPDATE** – Miles Murphy, MD

— **Wednesday, April 13, 2016** —

- 9:00 AM **Video Presentation 08**
USE OF SUPRAPUBIC CARTER-THOMASON
NEEDLE TO ASSIST IN CYSTOSCOPIC EXCISION OF
INTRAVESICAL FOREIGN OBJECT
J. Li; K. L. Armstrong; K. Gerson
Beth Israel Deaconess Medical Center, Boston, MA
- 9:10 AM **DISTINGUISHED SURGEON AWARD**
Supported by the Donald G. Gallup Fund
Presentation by SGS President Andrew Walter, MD
- 9:25 AM **PASSING OF THE GAVEL**
- 9:30 AM – 10:15 AM **Refreshments/View Posters/Video Café**
Esmeralda Pre-Function West
- 10:15 AM – 12:00 PM **Eighth Scientific Session**
Moderators: Peter Jeppson, MD, and
Vivian Sung, MD
Esmeralda Ballroom 1-4
- 10:15 AM **Oral Presentation 17**
COMPARING METHODS OF NSAID DELIVERY FOR
POSTOPERATIVE PAIN
S. D. Pickett¹; L. Quiroz¹; D. Zhao²; L. Anderlik³; M. A.
Nihira¹
¹Obstetrics and Gynecology, Female Pelvic Medicine
and Reconstructive Surgery, University of Oklahoma
Health Sciences Center, Oklahoma City,
OK, ²Department of Biostatistics and Epidemiology, The
University of Oklahoma Health Sciences Center,
Oklahoma City, OK, ³Obstetrics and Gynecology, The
University of Oklahoma Health Sciences Center,
Oklahoma City, OK

DISCUSSANT: Michael P. Diamond, MD

— **Wednesday, April 13, 2016** —

- 10:30 AM **Oral Presentation 18**
UNPLANNED THIRTY-DAY READMISSION RATES AS A QUALITY MEASURE: RISK FACTORS AND COSTS OF READMISSION ON A GYNECOLOGIC ONCOLOGY SERVICE
M. B. Wilbur¹; D. B. Mannschreck²; E. Tanner³; R. Stone³; K. Levinson⁴; S. Temkin³; F. Grumbine⁴; P. Pronovost²; A. Fader³
¹Gynecology & Obstetrics, Johns Hopkins Hospital , Baltimore, MD, ²Johns Hopkins School of Medicine, Baltimore, MD, ³Gynecologic Oncology, Johns Hopkins Hospital, Baltimore, MD, ⁴Gynecologic Oncology, Greater Baltimore Medical Center, Towson, MD

DISCUSSANT: Rebecca Margulies, MD
- 10:45 AM **Oral Poster 22**
PREVALENCE OF OCCULT PRE-MALIGNANT OR MALIGNANT PATHOLOGY AT THE TIME OF UTERINE MORCELLATION FOR BENIGN DISEASE
E. C. Von Barger^{1,2}; C. Grimes³; K. Mishra⁴; R. Wang²; M. Haviland²; J. Carnevale⁴; A. Estes⁵; M. D. Truong³; M. R. Hacker^{1,2}; E. A. Elkadry^{1,2}
¹Obstetrics and Gynecology, Mount Auburn Hospital, Cambridge, MA, ²Obstetrics and Gynecology, Beth Israel Deaconess Medical Center, Boston, MA, ³Obstetrics and Gynecology, Columbia University Medical Center, New York, NY, ⁴Obstetrics and Gynecology, Brown University, Providence, RI, ⁵Touro College of Osteopathic Medicine, New York, NY
- 10:49 AM **Oral Poster 23**
RISK FACTORS FOR 30-DAY PERIOPERATIVE COMPLICATIONS FOR TOTAL VAGINAL HYSTERECTOMY
A. Leader-Cramer; B. Dave; K. Bochenska; M. G. Mueller; C. Lewicky-Gaupp; K. Kenton
Female Pelvic Medicine and Reconstructive Surgery, Northwestern University, Chicago, IL
- 10:53 AM **Oral Poster 24**
PREVALENCE OF COGNITIVE IMPAIRMENT AMONG ELDERLY UROGYNECOLOGIC PATIENTS
E. R. Trowbridge; D. Kim; S. K. Larkin; V. Fitz; K. Barletta; K. Hullfish
OBGYN, University of Virginia , Charlottesville, VA

— **Wednesday, April 13, 2016** —

- 10:57 AM **Oral Posters Q & A**
- 11:00 AM **Video Presentation 09**
ALTERNATIVE OPTIONS FOR VISUALIZING
URETERAL PATENCY DURING INTRAOPERATIVE
CYSTOSCOPY
P. A. Rosa; S. M. Kambiss; R. Yordan
Ob/Gyn, San Antonio Military Medical Center, San
Antonio, TX
- 11:10 AM **Oral Presentation 19**
RATES OF INAPPROPRIATE OOPHORECTOMY AT
THE TIME OF BENIGN HYSTERECTOMY
A. S. Mahal¹; C. Elliott²; E. R. Sokol¹
¹OBGYN, Stanford Hospital, San Jose, CA, ²Urology,
Santa Clara Valley Medical Center, Santa Clara, CA
- DISCUSSANT:** Catherine Bradley, MD
- 11:25 AM **Oral Poster 25**
OUTCOMES OF LAPAROSCOPIC REMOVAL OF THE
ESSURE STERILIZATION DEVICE FOR PELVIC PAIN:
A CASE SERIES
J. Casey; A. Yunker
Obstetrics and Gynecology, Vanderbilt Medical Center,
Nashville, TN
- 11:29 AM **Oral Poster 26**
MEDIUM-TERM OUTCOMES OF ROBOTIC
SACROCOLPOPEXY USING ONLY ABSORBABLE
SUTURE FOR MESH FIXATIO
B. J. Linder; M. Anand; C. Klingele; E. Trabuco; J.
Gebhart; J. A. Occhino
Mayo Clinic, Rochester, MN
- 11:33 AM **Oral Posters Q & A**

— **Wednesday, April 13, 2016** —

- 11:35 AM **Oral Presentation 20**
TRANSDERMAL LIGHT NEUROMODULATION: FIRST INVESTIGATION OF OPTOGENETICS IN THE URINARY TRACT
R. S. Kelley¹; S. Wallace¹; G. Descalzi²; J. A. Fantl¹; C. Ascher-Walsh¹
¹OBGYN, Icahn School of Medicine at Mount Sinai, New York, NY, ²Neuroscience, Icahn School of Medicine Mount Sinai, New York, NY.

DISCUSSANT: Amy Park, MD
- 11:50 AM **Video Presentation 10**
SURGICAL APPROACHES TO THE MANAGEMENT OF BLADDER AND URETERAL ENDOMETRIOSIS
A. S. Benton¹; O. Sobowale¹; Y. Lin²; J. Raman²; G. J. Harkins¹
¹Obstetrics and Gynecology, Penn State Milton S Hershey Medical Center, Hershey, PA, ²Urology, Penn State Milton S Hershey Medical Center, Hershey, PA
- 12:00 PM **ADJOURN**

— Video Café —

These videos, as well as the 2014 and 2015 Annual Meeting videos,
are available throughout the meeting.

Esmeralda Boardroom

Video Café 26

SUPRAPUBIC PORT: THE KEY ACCESS POINT FOR TLH OF AN ENLARGED UTERUS

R. R. Pollard²; A. Petrikovets¹

¹Female Pelvic Medicine & Reconstructive Surgery, University Hospitals Case Medical Center, Cleveland, OH, ²Urogynecology/Minimally Invasive Gynecologic Surgery, MetroHealth Medical Center, Cleveland, OH.

Video Café 27

USE OF POSTERIOR COLPOTOMY TO MINIMIZE ABDOMINAL INCISIONS DURING LAPAROSCOPIC HYSTERECTOMY

G. Menderes; C. deHaydu; M. Azodi

Obstetrics, Gynecology and Reproductive Sciences, Yale University School of Medicine, West Haven, CT.

Video Café 28

TIPS AND TRICKS IN ROBOTICALLY ASSISTED LAPAROSCOPIC MYOMECTOMY FOR LARGE UTERI

N. Tang; P. Bral

Minimally Invasive Gynecologic Surgery, Maimonides Medical Center, Brooklyn, NY.

Video Café 29

LAPAROSCOPIC MESH EXCISION FOR MESH EROSION INTO THE BLADDER

S. Kasturi; W. Hilger; I. Bowen

Urogynecology Consultants, Sacramento, CA.

Video Café 30

LAPAROSCOPIC BURCH COLPOSUSPENSION

B. A. Garcia; R. Elkattah; S. Mohling; A. Yilmaz; R. Furr

Department of OB/GYN Division of Minimally Invasive Surgery, University of Tennessee Chattanooga College of Medicine, Chattanooga, TN.

Video Café 31

THE HYDRODISSECTION TECHNIQUE IN BILATERAL OVARIAN CYSTECTOMY FOR DERMOID CYSTS

R. Alammari¹; E. Greenberg^{2,1}

— *Video Café* —

¹Obstetrics and Gynecology, Baystate Medical center, Springfield, MA, ²Applied Medical , Rancho Santa Margarita, CA.

Video Café 32

DEVELOPMENT OF TRANSOBTURATOR VAGINAL TAPE PLACEMENT TEACHING MODEL

W. Chong

Obstetrics, Gynecology and Reproductive Sciences, Mount Sinai Medical Center, New York, NY.

Video Café 33

MESH EXTRUSION: LAPAROSCOPIC REMOVAL OF SACRAL HYSTEROPEXY MESH

K. N. Parthasarathy; J. B. Long; C. Pugh, DO

Obstetrics and Gynecology, The Reading Hospital and Medical Center, Wyomissing, PA.

Video Café 34

TISSUE GUIDED REGENERATIVE SURGERY: THE PATHOLOGY OF ANTERIOR VAGINAL WALL COLLAPSE

A. Nieuwoudt

Ziekenhuis Zorgsaam, Terneuzen, Netherlands.

Video Café 35

ROBOTIC MYOMECTOMY IN CONJUNCTION WITH OPEN EXCISION OF A HYDROCELE OF THE CANAL OF NUCK

L. E. Eisman³; S. L. Newman²; L. Barmat¹

¹Ob/Gyn, Abington Reproductive Medicine, Abington, PA, ²Surgery, Abington Memorial Hospital, Abington, PA, ³Ob/Gyn, Abington Memorial Hospital, Abington, PA.

Video Café 36

AN INNOVATIVE APPROACH TO THE SURGICAL MANAGEMENT OF A MISSED ABORTION

J. DeAnna¹; T. Bartlett¹; R. Raju²; O. Abuzeid²; J. Kingsbury¹; M. Abuzeid²

¹Genesys Regional Medical Center, Grand Blanc, MI, ²Hurley Medical Center, Flint , MI.

— *Video Café* —

Video Café 37

THE UTILITY OF INDOCYANINE GREEN IN LAPAROSCOPIC UTERINE ARTERY TRANSECTION

A. A. Adajar^{2,1}; J. V. Knaus²; M. Hanna²

¹Obstetrics and Gynecology, Presence Saint Joseph Hospital, Chicago, IL, ²Obstetrics and Gynecology, Presence Saint Francis Hospital, Evanston, IL.

Video Café 38

THE UTILITY OF LAPAROSCOPIC HYDRO-DISSECTION IN BLADDER DISSECTION, FROM A MID-LINE APPROACH.

A. A. Adajar

Minimally Invasive Gynecologic Surgery, IL Institute of Gynecology & Advanced Pelvic Surgery, Chicago, IL.

Video Café 39

THE USE OF THE RESECTOSCOPE IN THE MANAGEMENT OF ENDOMETRIAL POLYPS

J. DeAnna¹; T. Bartlett¹; R. Raju²; O. Abuzeid²; J. Kingsbury¹; M. Abuzeid²

¹Genesys regional medical center, Grand Blanc, MI, ²Hurley Medical Center, Flint, MI.

— Non-Oral Posters —

**Available Throughout The Meeting
Santa Rosa Patio**

Non-Oral Poster 27

POWER MORCELLATION PATTERNS OF GYNECOLOGIC SURGEONS

J. L. Hallock; C. Chen; M. Abernethy

GYN-OB, Johns Hopkins Bayview Medical Center, Baltimore, MD.

Non-Oral Poster 28

FACTORS ASSOCIATED WITH HEMOSTAT USE DURING LAPAROSCOPIC HYSTERECTOMY

A. B. Kakos^{3,1}; V. Allen^{2,4}; J. Whiteside^{1,3}

¹Division of Female Pelvic Medicine and Reconstructive Surgery, University of Cincinnati College of Medicine, Cincinnati, OH, ²Division of Ob/Gyn, The Christ Hospital, Cincinnati, OH, ³Urogynecology, The Christ Hospital, Cincinnati, OH, ⁴Obstetrics and Gynecology, The University of Cincinnati College of Medicine, Cincinnati, OH.

Non-Oral Poster 29

APICAL SUPPORT AT THE TIME OF HYSTERECTOMY FOR PELVIC ORGAN PROLAPSE: A COMPARISON OF APPROACHES

P. S. Fairchild¹; N. S. Kamdar¹; E. Rosen²; C. W. Swenson¹; D. M. Morgan¹

¹Department of Ob/Gyn, University of Michigan, Ann Arbor, MI, ²Obstetrics and Gynecology, University of Wisconsin, Madison, WI.

Non-Oral Poster 30

EVALUATION OF THE CARCINOGENIC POTENTIAL OF MESH USED IN THE TREATMENT OF FEMALE STRESS URINARY INCONTINENCE

B. J. Linder; E. Trabuco; D. Carranza; J. Gebhart; C. Klingele; J. A. Occhino
Mayo Clinic, Rochester, MN.

Non-Oral Poster 31

VISUOSPATIAL ABILITY AND PERFORMANCE IN THE OPERATING ROOM AMONG GYNECOLOGY RESIDENTS

R. Barr; S. Mathews; E. Moshier; C. Ascher-Walsh

Obstetrics and Gynecology, Mount Sinai School of Medicine, New York, NY.

Non-Oral Poster 32

EFFECT OF A NEW RISK CALCULATOR ON PATIENT SATISFACTION WITH THE DECISION FOR CONCOMITANT MIDURETHRAL SLING DURING PROLAPSE SURGERY: A RANDOMIZED CONTROLLED TRIAL

J. M. Miranne^{1,2}; R. E. Gutman³; A. I. Sokol³; A. J. Park³; C. Iglesia³

¹Urogynecology, Brigham and Women's Hospital, Boston, MA, ²Harvard

— *Non-Oral Posters* —

Medical School, Boston, MA, ³Female Pelvic Medicine and Reconstructive Surgery, Medstar Washington Hospital Center/Georgetown University School of Medicine, Washington.

Non-Oral Poster 33

THE NEGATIVE PREDICTIVE VALUE OF PREOPERATIVE URODYNAMICS FOR POST-OPERATIVE STRESS URINARY INCONTINENCE IN PATIENTS UNDERGOING PROLAPSE REPAIR

G. T. Sullivan; O. F. Duenas; K. Leung; M. K. Flynn

Obstetrics and Gynecology, University of Massachusetts Medical Center, Worcester, MA.

Non-Oral Poster 34

MAGNETOMYOGRAPHY OF THE LEVATOR MUSCLE COMPLEX: A NOVEL ASSESSMENT TOOL

S. S. Oliphant; D. Escalona-Vargas; B. Austin; A. McAlister; H. Eswaran
OB/GYN, University of Arkansas for Medical Sciences, Little Rock, AR.

Non-Oral Poster 35

CLINICAL DIAGNOSIS OF ADENOMYOSIS: USE OF PREDICTIVE UTERINE CHARACTERISTICS TO IMPROVE ACCURACY AND RELIABILITY

A. M. Sadecky^{1,2}; R. Guido²; T. Lee²; S. Mansuria²; N. Rindos²; N. M. Donnellan²

¹Obstetrics and Gynecology, Oregon Health & Science University, Portland, OR, ²Obstetrics and Gynecology, Magee Womens Hospital of UPMC, Pittsburgh, PA.

Non-Oral Poster 36

LENGTH OF CATHETER USE AFTER HYSTERECTOMY AS A RISK FACTOR FOR UTI

N. E. Karp¹; E. K. Kobernick¹; N. S. Kamdar¹; A. M. Fore²; D. M. Morgan¹

¹Division of Gynecology, Department of Obstetrics and Gynecology, University of Michigan, Ann Arbor, MI, ²Office of Performance Assessment and Clinical Effectiveness, Office of Clinical Affairs, University of Michigan, Ann Arbor, MI.

Non-Oral Poster 37

A HISTOLOGIC STUDY OF THE VAGINA IN FEMALE CADAVERIC DISSECTION

D. Mazloomdoost¹; L. B. Westermann¹; G. Mutema²; C. C. Crisp¹; S. D. Kleeman¹; R. N. Pauls¹

¹Division of Female Pelvic Medicine and Reconstructive Surgery,

— **Non-Oral Posters** —

TriHealth/Good Samaritan, Cincinnati, OH, ²Pathology, TriHealth/Good Samaritan Hospital, Cincinnati, OH.

Non-Oral Poster 38

SOCIAL NETWORKING AND INTERNET USE AMONG PATIENTS WITH PELVIC FLOOR COMPLAINTS: A MULTICENTER SURVEY STUDY

D. Mazloomdoost¹; R. Chan²; N. E. Deveneau³; G. Kanter⁴; A. M. Wyman⁵; E. Von Barga⁶; Z. Chaudhry⁷; J. M. Miranne⁸; C. M. Chu⁹; R. N. Pauls¹; L. A. Arya⁹; D. D. Antosh¹⁰

¹OBGYN, TriHealth/Good Samaritan, Cincinnati, OH, ²Northwoods Urology, The Woodlands, TX, ³University of Louisville, Louisville, KY, ⁴University of New Mexico, Albuquerque, NM, ⁵University of South Florida, Tampa, FL, ⁶Mount Auburn Hospital/Beth Israel Deaconess Medical Center, Boston, MA, ⁷University of California, Los Angeles, Los Angeles, CA, ⁸Medstar Washington Hospital Center, Washington, , ⁹University of Pennsylvania, Philadelphia, PA, ¹⁰Methodist Center for Restorative Pelvic Medicine, Houston, TX.

Non-Oral Poster 39

DETAILED HISTOLOGIC ANATOMY OF THE URETHRA IN FEMALE CADAVERIC DISSECTION

D. Mazloomdoost¹; L. B. Westermann¹; G. Mutema²; C. C. Crisp¹; S. D. Kleeman¹; R. N. Pauls¹

¹Division of Female Pelvic Medicine and Reconstructive Surgery, TriHealth/Good Samaritan, Cincinnati, OH, ²Pathology, TriHealth/Good Samaritan, Cincinnati, OH.

Non-Oral Poster 40**

EFFECT OF RADIOFREQUENCY ENDOMETRIAL ABLATION ON DYSMENORRHEA

S. Wyatt¹; T. Banahan¹; Y. Tang¹; K. Nadendla²; J. M. Szychowski¹; T. Jenkins¹

¹OBGYN, University of Alabama Birmingham, Birmingham, AL, ²School of Medicine, University of Alabama-Birmingham, Birmingham, AL.

**Member Candidate Presentation

Non-Oral Poster 41

LAPAROSCOPIC SKILLS LABS: IMPACTING SELF-ASSESSMENT THROUGH CONFIDENCE.

J. H. Chen^{1,2}; D. Bruggemann²; N. Brown³

¹Obstetrics and Gynecology, Los Angeles County Department of Health Services, San Gabriel, CA, ²Obstetrics and Gynecology, University of Southern California, Los Angeles, CA, ³Preventive Medicine, University of Southern California, Los Angeles, CA.

— *Non-Oral Posters* —

Non-Oral Poster 42

MEDICARE CLAIMS BY REGION AND PHYSICIAN PRACTICE TYPE IN OB/GYN

S. Hussain^{1,3}; F. Thida⁴; A. Gupta²; J. Whiteside³

¹CHRIST HOSPITAL, Cincinnati, OH, ²Crozer-Chester Medical Center, Upland, PA, ³University of Cincinnati, Cincinnati, OH, ⁴Dartmouth University, Hanover, NH.

Non-Oral Poster 43

VARIABLES AFFECTING MAXIMUM URETHRAL CLOSURE PRESSURE (MUCP) AND ABDOMINAL LEAK POINT PRESSURE (ALPP) MEASUREMENTS

B. J. Hill¹; S. A. Fletcher²; J. Blume²; R. M. Ward¹

¹OB/GYN, Vanderbilt University, Nashville, TN, ²Biostatistics, Vanderbilt University, Nashville, TN.

Non-Oral Poster 44

COMPLEX CONDUCTIVITY OF NORMAL AND NEOPLASTIC UTERUS

R. S. Kelley¹; A. Tran¹; D. Isaacson³; J. Newell²; G. Saulnier²; A. Vargas³; K. Zakashansky¹; C. Ascher-Walsh¹

¹OB/GYN, Icahn School of Medicine at Mount Sinai, New York, NY, ²Electrical, Computer, and Systems Engineering, Rensselaer Polytechnic Institute, Troy, NY, ³Mathematics, Rensselaer Polytechnic Institute, Troy, NY.

Non-Oral Poster 45

ESSURE REMOVAL FOR PRESUMED DEVICE SIDE-EFFECTS: A CASE SERIES AND SYSTEMATIC LITERATURE REVIEW

C. Arora; S. Shazly; S. Laughlin; M. Hopkins; D. Breittkopf; A. Famuyide
Obstetrics and Gynecology, Mayo Clinic, Rochester, MN.

Non-Oral Poster 46

LOW FIDELITY CONTAINED MANUAL TISSUE EXTRACTION SIMULATION IMPROVES RESIDENT CONFIDENCE

C. A. Saad¹; C. Templeman¹; J. M. Jaque¹; M. Minneti²

¹Obstetrics and Gynecology, University of Southern California, Keck School of Medicine, Los Angeles, CA, ²Surgery, University of Southern California, Keck School of Medicine, Los Angeles, CA.

Non-Oral Poster 47

THE ROLE OF VIRTUAL REALITY SIMULATION IN THE EVALUATION OF LAPAROSCOPIC SKILLS IN GYNECOLOGY

S. Mathews; F. Friedman; A. Weinberg; M. Brodman; C. Ascher-Walsh
Icahn School of Medicine at Mount Sinai, New York, NY.

— *Non-Oral Posters* —

Non-Oral Poster 48

PERIOPERATIVE COMPLICATIONS FOLLOWING COLPOCLEISIS WITH CONCOMITANT VAGINAL HYSTERECTOMY

K. Bochenska; A. Leader-Cramer; M. G. Mueller; B. Dave; C. Lewicky-Gaupp; A. Alverdy; K. Kenton

Female Pelvic Medicine and Reconstructive Surgery, Northwestern University, Chicago, IL.

Non-Oral Poster 49

URINARY TRACT INFECTION RATES AFTER PASSIVE AND ACTIVE TRIAL OF VOID

L. H. Jambusaria¹; A. P. Davenport²; B. J. Hill¹; R. Adam¹

¹Obstetrics & Gynecology, Vanderbilt University, Nashville, TN, ²Charles E Schmidt College of Medicine, Florida Atlantic University, Boca Raton, FL.

Non-Oral Poster 50

COMBINED NATURAL ORIFICE SINGLE SITE LAPAROSCOPY: C-NOSS

A. Hill¹; L. M. Hammons¹; L. Clark¹; M. Azodi^{1,2}

¹Yale New Haven Health - Bridgeport Hospital, Bridgeport, CT, ²Yale New Haven Hospital, New Haven, CT.

Non-Oral Poster 51

COMPARISONS OF FUNCTIONAL SUPPORT WITH SACROHYSTEROPEXY VERSUS SACROCOLPOPEXY: A CADAVERIC STUDY.

P. A. Maldonado; L. Jackson; M. Florian-Rodriguez; C. Y. Wai

OB/GYN, UT Southwestern Medical Center, Dallas, TX.

Non-Oral Poster 52

TREATMENT OF ASHERMANS SYNDROME WITH AN INTRAUTERINE AMNIOGRAFT TO PROVIDE A “SCAFFOLD” PLATFORM FOR ENDOMETRIAL CELL REGENERATION

G. Collins; S. Thakore; B. Patel; J. Liu

University Hospitals Case Medical Center, Cleveland, OH.

Non-Oral Poster 53

PREVALENCE OF DEFECATORY SYMPTOMS IN PATIENTS WITH POSTERIOR VAGINAL WALL DEFECTS ON DYNAMIC MRI

M. T. Nguyen¹; S. Cohen²; C. C. Pan³; V. N. Vu⁴; J. Y. Mei⁵; E. Fisseha⁵; Z. Chaudhry¹; E. I. Kreydin²; J. L. Oliver²; S. Raz²; C. Tarnay¹

¹Obstetrics and Gynecology, Female Pelvic Medicine and Reconstructive Surgery, UCLA, Los Angeles, CA, ²Urology, Female Pelvic Medicine and Reconstructive Surgery, UCLA, Los Angeles, CA, ³Obstetrics and Gynecology, University of Texas , Houston, TX, ⁴Biostatistics , UCLA School of Public

— *Non-Oral Posters* —

Health, Los Angeles, CA, ⁵David Geffen School of Medicine, UCLA, Los Angeles, CA.

Non-Oral Poster 54

CORE PRIVILEGING: HOSPITALS' APPROACH TO GYNECOLOGIC SURGERY

M. Siddique^{1,6}; N. Shah^{1,6}; A. J. Park^{1,6}; B. Chen²; S. Emery²; T. Falcone³; R. Margulies⁴; C. Rardin⁵; C. Iglesia^{1,6}

¹OBGYN, MedStar Washington Hospital Center, Washington, , ²OBGYN, Magee-Womens Hospital of UPMC, Pittsburgh, PA, ³OBGYN, Cleveland Clinic Foundation, Cleveland, OH, ⁴OBGYN, Kaiser Oakland, Oakland, CA, ⁵OBGYN, Women and Infants' Hospital of Rhode Island, Providence, RI, ⁶OBGYN, Georgetown University School of Medicine, Washington.

Non-Oral Poster 55

INTRAVERSICAL ELECTRICAL STIMULATION (IVES) TREATMENT FOR OVERACTIVE BLADDER SYNDROME (OAB): A PILOT STUDY

J. J. Yune; J. Shen; J. Hardesty; J. Kim; S. Siddighi
Loma Linda University , Loma Linda, CA.

Non-Oral Poster 56

ROBOTICALLY ASSISTED VERSUS VAGINAL HYSTERECTOMY

M. Wasson; K. A. Butler; J. F. Magrina
Gynecologic Surgery, Mayo Clinic Arizona, Phoenix, AZ.

Non-Oral Poster 57

LONG-TERM EFFECT OF INSTITUTING A LAPAROSCOPIC CURRICULUM ON KNOWLEDGE OF OBGYN RESIDENTS

C. De Amorim Paiva; N. Tang; P. Bral
Maimonides Medical Center, Brooklyn, NY.

Non-Oral Poster 58

FEASIBILITY, SAFETY, AND PREDICTION OF COMPLICATIONS FOR COMPLEX MINIMALLY INVASIVE MYOMECTOMY

M. V. Vargas¹; G. Moawad¹; C. Sievers^{3,4}; j. Opoku-Anane²; C. Marfori¹; J. Robinson⁵

¹Division of Gynecology, George Washington University Medical Center, Washington, , ²Obstetrics and Gynecology, University of San Francisco, San Francisco, CA, ³Department of Pathology and Center for Cancer Research, Massachusetts General Hospital, Boston, MA, ⁴Broad Institute of Massachusetts Institute of Technology and Harvard, Cambridge, MA, ⁵Minimally Invasive Surgery, MedStar Washington Hospital Center, Washington.

— Non-Oral Posters —

Non-Oral Poster 59

GENITOURINARY FISTULA: A PROSPECTIVE STUDY OF TRANSABDOMINAL APPROACH FOR 67 COMPLICATED CASES AT A TERTIARY CARE HOSPITAL, KHARTOUM- SUDAN

A. Fazari^{1,2}

¹Faculty of Medicine, University of Medical Science and Technology, Khartoum, Sudan, ²Omdurman Maternity Hospital , Khartoum, Sudan.

Non-Oral Poster 60

FECAL INCONTINENCE KNOWLEDGE QUESTIONNAIRE (FIKQ): VALIDATING AN INSTRUMENT TO ASSESS KNOWLEDGE OF FECAL INCONTINENCE IN WOMEN

J. Chao¹; L. Lundberg¹; H. Park²; B. Nhundu³; P. Torres⁴; A. Desire⁵; K. Levy¹; M. Guess¹

¹Obstetrics, Gynecology, and Reproductive Sciences, Yale University School of Medicine, New Haven, CT, ²Yale University School of Nursing, New Haven, CT, ³Yale University School of Medicine, New Haven, CT, ⁴Yale New Haven Hospital, New Haven, CT.

Non-Oral Poster 61

UNDERSTANDING PRE-OPERATIVE STAGING AND SURGICAL PRACTICE IN ADVANCED ENDOMETRIOSIS

A. I. Nica; G. Liu; A. Selk; J. Kroft

Obstetrics and Gynaecology, University of Toronto, Toronto, Ontario, Canada

Non-Oral Poster 62

SURGICAL ANATOMY OF VAGINAL SACROCOLPOPEXY

K. Jallad; L. N. Siff; M. D. Walters; M. R. Paraiso
Cleveland Clinic, Cleveland, OH.

Non-Oral Poster 63

MINIMALLY INVASIVE HYSTERECTOMY FOR UTERI GREATER THAN 1 KILOGRAM

T. Ito; M. Vargas; M. Shu; J. Opoku-Anane; G. Moawad; C. Marfori; J. Robinson

OB/GYN, The George Washington University , Arlington, VA.

Non-Oral Poster 64

VARIABILITY OF COMMERCIAL CRANBERRY PRODUCTS FOR THE PREVENTION OF UROPATHOGENIC BACTERIAL ADHESION

B. Chughtai¹; J. C. Forde¹; A. Howell²

¹Dept. of Urology, Weill Medical College of Cornell University, New York,

— **Non-Oral Posters** —

NY, ²Rutgers University, Marucci Center for Blueberry and Cranberry Research, New Brunswick, NJ.

Non-Oral Poster 65

CONTRACEPTIVE CHOICES AFTER ENDOMETRIAL ABLATION FROM 2007-2012 AT AN ACADEMIC MEDICAL CENTER.

J. Beissel; D. Breitkopf; A. Famuyide; M. Hopkins; S. Shazly; S. Laughlin
Obstetrics and Gynecology, Mayo Clinic, Rochester, MN.

Non-Oral Poster 66

LAPAROSCOPIC AND ROBOTIC MYOMECTOMY: COMPARISON OF COST AND PERIOPERATIVE OUTCOMES FOR COMPLEX CASES

M. V. Vargas¹; G. Moawad¹; C. Marfori¹; j. Opoku-Anane²; J. Robinson³
¹Division of Gynecology, George Washington University Medical Center, Washington, , ²Obstetrics and Gynecology, University of California San Francisco, San Francisco, CA, ³Division of Minimally Invasive Gynecology, MedStar Washington Hospital Center, Washington.

Non-Oral Poster 67

VOIDING DYSFUNCTION AND LOWER URINARY TRACT SYMPTOMS AFTER NATIVE TISSUE VERSUS GRAFT-AUGMENTED VAGINAL PROLAPSE REPAIR

Q. K. Lippmann^{1,2}; A. Stewart¹; J. Tan-Kim²
¹Reproductive Medicine, UCSD, Del Mar, CA, ²Urogynecology, Kaiser Permanente, San Diego, CA.

Non-Oral Poster 68

WELCOMING TRANSGENDER PATIENTS TO THE GYNECOLOGIST'S OFFICE

L. S. Mihalov^{1,2}
¹Gynecology, Virginia Mason Medical Center, Seattle, WA, ²Obstetrics and Gynecology, University of Washington School of Medicine, Seattle, WA.

Non-Oral Poster 69

DYNAMIC MRI FOR THE DETECTION OF POSTERIOR VAGINAL WALL DEFECTS AND ITS ASSOCIATION WITH CLINICAL IN-OFFICE EXAM VERSUS INTRAOPERATIVE EXAM UNDER ANESTHESIA

M. T. Nguyen¹; S. Cohen²; C. C. Pan³; V. N. Vu⁴; J. Y. Mei⁵; E. Fisseha⁵; Z. Chaudhry¹; E. I. Kreydin²; J. L. Oliver²; S. Raz²; C. Tarnay¹
¹Obstetrics and Gynecology, Female Pelvic Medicine and Reconstructive Surgery, University of California, Los Angeles, Los Angeles, CA, ²Urology, Female Pelvic Medicine and Reconstructive Surgery, University of California, Los Angeles, Los Angeles, CA, ³Obstetrics and Gynecology, University of Texas, Houston, TX, ⁴Biostatistics, School of Public Health, University of

— **Non-Oral Posters** —

California, Los Angeles, Los Angeles, CA, ⁵David Geffen School of Medicine, University of California, Los Angeles, Los Angeles, CA.

Non-Oral Poster 70

THE EFFECTS OF ROBOTIC INSTRUMENTATION ON THE STRETCH ABILITY OF VARIOUS TYPES OF POLYPROPYLENE MESH UTILIZED IN SACRAL COLPOPEXY

A. Agrawal; D. Hobson; C. L. Kinman; N. E. Deveneau; K. V. Meriwether; S. L. Francis
Female Pelvic Medicine and Reconstructive Surgery, University of Louisville, Louisville, KY.

Non-Oral Poster 71

DEFINING PHYSICAL ACTIVITY AND SEDENTARY BEHAVIOR AND ITS RELATIONSHIP TO INCONTINENCE IN OLDER ADULTS WITH URINARY INCONTINENCE

C. M. Chu¹; K. H. Schmitz²; L. A. Arya¹; D. K. Newman³; U. U. Andy¹
¹Obstetrics & Gynecology, University of Pennsylvania, Philadelphia, PA, ²Center for Clinical Epidemiology and Biostatistics, University of Pennsylvania School of Medicine, Philadelphia, PA, ³Urology, University of Pennsylvania, Philadelphia, PA.

Non-Oral Poster 72

OUTCOMES FOLLOWING PHYSICAL THERAPY UTILIZING SHORT-WAVE DIATHERMY FOR THE TREATMENT OF CHRONIC PELVIC PAIN

J. N. Byrnes¹; A. Hokenstad²; N. Cookson³; A. Sadowy³; J. A. Occhino¹
¹Female Pelvic Medicine and Reconstructive Surgery, Mayo Clinic, Rochester, MN, ²Gynecologic Oncology, Mayo Clinic, Rochester, MN, ³Physical Therapy, Mayo Clinic, Rochester, MN.

Non-Oral Poster 73

ACCURACY OF BLADDER SCANNER MEASUREMENTS IN PATIENTS WITH PELVIC ORGAN PROLAPSE

N. E. Deveneau; J. G. Theisen; A. Agrawal; C. L. Kinman; S. L. Francis
OB/GYN, University of Louisville, Louisville, KY.

Non-Oral Poster 74

AN EXERCISE INTERVENTION PROGRAM IN OLDER COMMUNITY-DWELLING WOMEN WITH URINARY INCONTINENCE: A MIXED METHODS FEASIBILITY STUDY

A. Pahwa; K. H. Schmitz; U. U. Andy; D. K. Newman; L. A. Arya
University of Pennsylvania, Philadelphia, PA.

— *Non-Oral Posters* —

Non-Oral Poster 75

WHEN DO WE SEE OUR POSTOPERATIVE PATIENTS?

M. G. Mueller³; A. Alverdy; C. Lewicky-Gaupp; A. Leader-Cramer; B. Dave; K. Kenton

OB/GYN, Northwestern University Feinberg School of Medicine, Chicago, IL.

Non-Oral Poster 76

SURGEON FACTORS INFLUENCE PERFORMANCE OF PROPHYLACTIC SALPINGECTOMY DURING BENIGN HYSTERECTOMY

K. Mishra³; C. Grimes⁷; E. Von Bargen^{4,5,6}; J. Carnevale¹; P. Has²; R. Wang^{4,6}; E. A. Elkadry^{4,5,6}

¹Department of Obstetrics & Gynecology, Brown University, Providence, RI, ²Department of Obstetrics & Gynecology, Division of Research, Brown University, Providence, RI, ³Department of Obstetrics & Gynecology, Division of Urogynecology & Reconstructive Pelvic Surgery, Brown University, Providence, RI, ⁴Department of Obstetrics & Gynecology, Beth Israel Deaconess Medical Center, Boston, MA, ⁵Department of Obstetrics & Gynecology, Mount Auburn Hospital, Cambridge, MA, ⁶Department of Obstetrics, Gynecology, & Reproductive Biology, Harvard Medical School, Boston, MA, ⁷Department of Obstetrics & Gynecology, Columbia University Medical Center, New York, NY.

Non-Oral Poster 77

BLADDER MANAGEMENT FOLLOWING VAGINAL SURGERY FOR PELVIC ORGAN PROLAPSE

M. Anand^{1,2}; M. Carbone³; C. Heisler^{1,2}; T. Koehler³; A. Davis³

¹OB/GYN, Michigan State University, Grand Rapids, MI, ²Women's Health, Spectrum Health Medical Group, Grand Rapids, MI, ³Grand Rapids Medical Education Partners, Grand Rapids, MI.

Non-Oral Poster 78

COMPARISON OF TOTAL VAGINAL HYSTERECTOMY AND ROBOT-ASSISTED TOTAL LAPAROSCOPIC HYSTERECTOMY: A RETROSPECTIVE STUDY

A. Ramaseshan¹; N. Ghassemzadeh²; O. Turan¹; K. Audlin²

¹University of Maryland Medical Center, Baltimore, MD, ²Mercy Medical Center, Baltimore, MD.

Non-Oral Poster 79

COMPARISON OF TIMES TO URETERAL EFFLUX AFTER ADMINISTRATION OF SODIUM FLUORESCEIN VERSUS PHENAZOPYRIDINE

S. Cohen²; M. T. Nguyen¹; Z. Chaudhry¹; J. L. Oliver²; E. I. Kreydin²; S. Mills³; A. L. Ackerman²; J. Kim²; S. Raz²; C. Tarnay¹

¹Obstetrics and Gynecology, Female Pelvic Medicine and Reconstructive

— Non-Oral Posters —

Surgery, University of California, Los Angeles, Los Angeles, CA, ²Urology, Female Pelvic Medicine and Reconstructive Surgery, University of California, Los Angeles, Los Angeles, CA, ³Urology, University of California, Los Angeles, Los Angeles, CA.

Non-Oral Poster 80

EVALUATION OF MANAGEMENT OF PATIENTS WITH OVERACTIVE BLADDER (OAB) AND FECAL INCONTINENCE (FI)- PAVING THE CARE PATHWAY FOR THE FUTURE.

N. Noor^{1,2,3}; P. L. Rosenblatt^{1,2}

¹Urogynecology, Mount Auburn Hospital, Cambridge, MA, ²Obstetrics and Gynecology, Harvard Medical School, Cambridge, MA, ³Obstetrics and Gynecology, Beth Israel Deaconess Medical Center, Boston, MA.



Donors

Donor information is as of March 10, 2016.



Ambassador

\$10,000 - \$24,999

Andrew Cassidenti
Ed and Deborah Gallup
Pam Gallup Gaudry

Champion

\$5,000 - \$9,999

Michael P. Aronson Family
Cheryl Iglesia
Thomas E. Nolan
Holly E. Richter
R. Edward Varner

Mentor

\$2,500 - \$4,999

James L. Breen
Nancy Frankel and Lennie Siegel
John Gebhart
LABORIE
Stephen Metz
Kris Strohbehn

Advocate

\$1,000 - \$2,499

W. Allen Addison
Peter Bulla
Geoffrey W. Cundiff
LaFloyd and Elaine Hobbs
Charles R. Rardin
Bob Shull
Andrew J. Walter
Sheldon Weinstein



Patron
\$1 - \$999

Arnold Advincula	Kristina Butler	Terry S. Dunn
Vivian Aguilar	Cassandra	Karolynn T. Echols
Mallika Anand	Carberry	Mark Ellerkmann
Danielle Antosh	James Carter	David Ellington
Kathryn Arendt	Charelle Carter-	Sherif El-Nashar
David Aronson	Brooks	Elisabeth Erekson
Lily Arya	Elizabeth Casiano	Elisabeth Evans
Marc Ashby	Ralph Chesson	Linda Fan
Tirsit Asfaw	C. Sage Claydon	Tola Fashokun
Jamie Bakkum-	Jeffrey L. Clemons	Dee Fenner
Gamez	William Cliby	Paul Fine
Scott Bailey	Cogentix Medical	Seth Finkelstein
Alicia Ballard	Sarah Collins	Raymond Foster
Heather Barbier	Ellen Conner	Sean Francis
Matthew Barker	Jeffrey Cornella	Anna Frick
Ahmet Bedestani	Catrina Crisp	Rajiv Gala
Roberta E. Blandon	Andrew Croak	Kim Gerten
Joan Blomquist	John O. L.	Mohamed A.
Bryce Bowling	DeLancey	Ghafar
Jessica Bracken	Gouri Diwadkar	Dobie Giles
Amber Bradshaw	Sean Dowdy	Jon Gleason
Linda Brubaker	Peter Drewes	Karen Gold



Patron (Continued)
\$1 - \$999

Bobbie Gostout	Lennox Hoyte	Anuradha Koduri
Elliot Greenberg	R. Keith Huffaker	Yoko Komesu
Jerod Greer	William W. Hurd	Ernest I. Kohorn
Meghan Griffin	Okey Ibeanu	Yoko Komesu
Robert Gutman	Tiffany Jackson	Nicole Korbly
Douglass Hale	Karl Jallad	Abner P. Korn
Cynthia Hall	Van Jenkins	Nathan Kow
Barry Hallner	Peter Jeppson	Bela Kudish
Robert Hammer	Lisa Johnson	Kristina Kwon
Harriette Hampton	Scott Kambiss	Felicia Lane
Star Hampton	Padma Kandadai	Wilma Larsen
Oz Harmanli	Mickey Karram	Christine LaSala
Shireen Heidari	Nadine Kassis	Melinda Letterman
Christine Heisler	Kimberly Kenton	Jaime Long
John Michael	Rosanne Kho	Michael Maddox
Heusinkveld	Laura Kim	Mamta Mamik
Wesley S. Hilger	Shunaha Kim Fine	Rebecca Margulies
Audra Jo Hill	Jennifer Klauschie	Andrea Mariani
Brian Hines	Christopher	Arnulfo Martinez
Deslyn Hobson	Klinge	Kristen Matteson
Tonya Hoke	Sharon Knight	Paul McChristian
Denise Howard	Leise Knoepp	George McClure



Patron (Continued)
\$1 - \$999

Brook McFadden	Apurva Pancholy	Amanda Sadecky
Mary T. McLennan	Marie Paraiso	Joy Saini
Carlos A. Medina	Amy Park	Katherine Sandhu
Kate Meriwether	Candice Parker-	Tatiana Sanses
John Miklos	Autry	William Schlaff
Jeannine Miranne	Rachel Pauls	Jennifer Schmitt
Douglas Miyazaki	Lisa M. Peacock	Mitchell Schuster
Michael Moen	Paul D. Pettit	Saya Segal
Stephanie Molden	Anna Pilzek	William Seifert
Ignacio Montoya	Antonio Pizarro	Sangeeta Senapati
Michelle Morrill	Karl C. Podratz	Abbas Shobeiri
Abraham Morse	Arash Rahi	David Shveiky
Tyler Muffly	Lise Rehwaldt	Lauren Siff
Tristi Muir	Lee Richter	Ruchira Singh
Miles Murphy	Beri Ridgeway	Ambereen Sleemi
Deborah Myers	Noah Rindos	Scott W. Smilen
Mikio Nihira	Jeanette Rivera	Carl Smith
Michael Noone	Marcella L.	Katelyn Smithling
Gina Northington	Roennburg	Andrew Sokol
Peggy Norton	Rebecca Rogers	Eric Sokol
Patrick Nosti	Robert Rogers	Ellen Solomon
Susan Oakley	Peter Rosenblatt	Arlene Song
John Occhino	Amy Rosenman	Karen Soules



Patron (Continued)
\$1 - \$999

Edward Stanford	Cecile Unger	Thomas Wheeler
Ryan Stratford	Babak Vakili	James Whiteside
Kevin Stepp	Brett Vassallo	Heather Willis
Ryan Stewart	Cliff Wai	Anne K. Wiskind
Vivian Sung	Mark Walters	Joshua Woelk
Kimberly Swan	Briana Walton	Kyle Wohlrab
Karl F. Tamussino	K. Wang	Hugh Wolcott
Bernard Taylor	Renee Ward	Michael Woods
James P. Theofrastous	Blair Washington	Sabrina Wyatt
Marc Toggia	Richard Wasserman	Jennifer Yeung
Emanuel Trabuco	Emily Weber	Johnny Yi
Mireille Truong	LeBrun	Ladin Yurteri- Kaplan
Paul Tulikangas	Alison Weidner	Wong T. Zheng
Elana Tunitsky- Bitton	Lauren Westerman	Carl Zimmerman
		Dani Zoorob



Michael P. Aronson, MD, Fund Donors

Rony Adam	Dobie Giles	Michael Moen
Arnold Advincula	Elliot Greenberg	Deborah Myers
Mallika Anand	Douglass Hale	Thomas E. Nolan
David Aronson	Wesley Hilger	Holly E. Richter
Michael P.	Lennox Hoyte	Rebecca Rogers
Aronson Family	William W. Hurd	Robert Rogers
James L. Breen	Lisa Johnson	Amy Rosenman
Linda Brubaker	Scott Kambiss	Joy Saini
Peter Bulla	Padma Kandadai	Tatiana Sanses
Andrew Cassidenti	Mickey Karram	Bob Shull
Ralph Chesson	Kimberly Kenton	William Schlaff
Jeffrey Clemons	Ernest I. Kohorn	Mitchell Schuster
Jeffrey L. Cornella	Yoko Komesu	Kris Strohbehn
John O. L.	Abner P. Korn	Vivian Sung
DeLancey	LABORIE	Bernard Taylor
Peter Drewes	Christine LaSala	R. Edward Varner
Mark Ellerkmann	Melinda Letterman	Andrew J. Walter
Elisabeth Erikson	Jaime Long	Emily Weber
Dee Fenner	Michael Maddox	LeBrun
Nancy Frankel &	Arnulfo Martinez	Anne K. Wiskind
Lennie Siegel	George McClure	
John Gebhart	Stephen Metz	



Donald G. Gallup, MD, Fund Donors

Scott Bailey

Heather Barbier

Andrew Cassidenti

Ralph R. Chesson

Ed & Deborah Gallup

Pam Gallup

Harriette Hampton

LaFloyd and Elaine Hobbs

Melinda Letterman

Paul McChristian

Stephen Metz

Michael Moen

Thomas E. Nolan

Peggy Norton

Karl C. Podratz

William Seifert

Bob Shull

Carl Smith

Bernard Taylor

R. Edward Varner

Sheldon Weinstein

Hugh Wolcott



In Memory Of

*In Memory of Marvin H. Terry Grody
Sheldon Weinstein and Carl Zimmerman*

Second Michael P. Aronson Educational Scholarship Recipient *Aimee Ferrandino, MD*



Dr. Ferrandino is an assistant professor at Duke University Medical Center in Durham North Carolina. She is part of the Division of Benign Gynecology. Dr. Ferrandino is the co-supervisor of the resident continuity clinic. She provides clinical and surgical training to residents and students. She provides care to the indigent population. She is a consistent advocate for these patients and wants them to get the most comprehensive care despite significant barriers. She is dedicated to teaching the physicians of the future.

SGS Membership

— Membership Roster —

Philip D. Abbott, MD**2004**

3700 Rufe Snow Dr.
Fort Worth, TX 76180
aa2266@aol.com

Husam Abed, MD**2015**

2500 North State St, L313
Jackson, MS 39216
601-984-5306
abedgh@yahoo.com

Rony Adam, MD**2000**

B-1100 MCN
Nashville, TN 37232
615-322-8968
r.adam@vanderbilt.edu

Arnold Advincula, MD**2006**

622 West 168th Street
New York, NY 10032
407-618-6304
aa3530@cumc.columbia.edu

Thomas Aigmueller, MD**2016**

Auenbruggerplatz 14
Graz, Austria 8036
aigmueller@gmail.com

Mohamed Akl, MD**2016**

6632 E. Baseline Rd. #101
Mesa, AZ 85206
480-889-2654
drmoakl@gmail.com

Cindy Amundsen, MD**2000**

Duke Univ. Medical Center
Durham, NC 27707
cindy.amundsen@duke.edu

Danielle Antosh, MD**2016**

6560 Fannin, Suite 2100
Houston, TX 77030
713-818-5813
ddantosh@houstonmethodist.org

Lily A. Arya, MD**/2009**

1000 Courtyard 3400 Spruce Street
Philadelphia, PA 19104
Larya@obgyn.upenn.edu

Charles Ascher-Walsh, MD**2010**

Mt. Sinai Hospital / Dept. OB.GYN
New York, NY 10029
charles.ascher-walsh@mssm.edu

Arnim Bader, MD**2009**

Medical University of Graz
Graz, Austria 0
arnim.bader@medunigraz.at

Sunil Balgobin, MD**2012**

5323 Harry Hines Boulevard
Dallas, TX 75390
214-648-6430
sunil.balgobin@utsouthwestern.edu

Matthew Barber, MD**2007**

9500 Euclid Ave/A81
Cleveland, OH 44195
216-445-0439
barberm2@ccf.org

Joan M. Bengtson, MD**1995**

850 Boylston Ave., Suite 402
Chestnut Hill, MA 2467
jbengtson@partners.org

— Membership Roster —

Alfred Bent, MD**2007**

PO Box 367
Brookfield, NS 0
902-673-2953
alfred.bent@gmail.com

Todd Beste, MD**2009**

SEAHEC, OB/GYN 2131 S.
17th St.
Wilmington, NC 28402
Todd.Beste@seahec.net

Megan Billow, DO**2016**

11100 Euclid Avenue
Cleveland, OH 44106
216-844-1000
meganbillow1@gmail.com

Jody Blanco, MD**1995**

161 Fort Washington Ave. Suite
447
New York, NY 10032
jsb7@columbia.edu

Deirdre Bland, MD**1999**

Blue Ridge Medical Associates
Winston-Salem, NC 27103
bland.blueridge@gmail.com

Roberta Blandon, MD**2012**

4401 Wornall RD, 3rd Floor Peet
Center
Kansas City, MO 64111
816-932-1785
rblandon@saint-lukes.org

Joan Blomquist, MD**1/1/2014**

6569 North Charles Street
Baltimore, MD 21204
jblomqui@gbmc.org

Michael Bonidie, MD**2006**

300 Halket Street
Pittsburgh, PA 15213
bonidiemj@mail.magee.edu

C. Bryce Bowling, MD**2012**

1932 Alcoa Highway, Suite C-450
Knoxville, TN 37920
865-305-5940
cbbowlingmd@gmail.com

Sarah H. Boyles, MD**2009**

9155 SW Barnes Rd., Suite 634
Portland, OR 97225
sboyles@orclinic.com

Catherine Bradley, MD**2008**

200 Hawkins Dr., 51217 PFP
Iowa City, IA 52242
319-356-1534
catherine-bradley@uiowa.edu

John Breen, MD**1997**

2821 Michaelangelo Dr., Suite 400
Edinburg, TX 78539
956-362-3566
jmbreenmd@gmail.com

— Membership Roster —

Linda Brubaker, MD**1995**

2160 S. First Avenue, #417
Maywood, IL 60153
708-216-2236
lbrubaker@luc.edu

Gunhilde M. Buchsbaum, MD**2007**

University of Rochester Medical
Center
Rochester, NY 14642
gunhilde_buchsbaum@urmc.roche
ster.edu

Richard C. Bump, MD**1989**

131 Cub Highland
Nellysford, VA 22958
434 361-1824
rcbump0621@gmail.com

David B. Byck, MD**1995**

4750 Waters Ave. Suite 400
Savannah, GA 31404
ByckDa1@memorialhealth.com

Ricardo Caraballo, MD**2004**

University Urogynecology
Associates
Voorhees, NJ 8043
856-325-6622
caraballo-
ricardo@cooperhealth.edu

Andrew Cassidenti, MD**2012**

1010 W. La Veta, Suite 775
Orange, CA 92868
714 954-0270
abruin4ev@aol.com

Chi Chiung Grace Chen, MD**2012**

301 Building Room 3118
Baltimore, MD 21224
cchen127@jhmi.edu

Ralph R. Chesson, MD**1995**

Dept. of OB/GYN 324 Walnut St.
New Orleans, LA 70118
rchess@lsuhsc.edu

Hilary Cholhan, MD**1995**

500 Helendale Road Suite 265
Rochester, NY 14609
585-266-2360
boxsterone@frontiernet.net

C. Sage Claydon, MD**2010**

1098 West Baltimore Pike Health
Center 3, #3404
Media, PA 19063
610-627-4170
info@drclaydon.com

Jeffrey Clemons, MD**2005**

1901 S. Union Ave., Suite B-2006
Tacoma, WA 98405
drclemons@yahoo.com

Sarah Collins, MD**2015**

5841 S. Maryland Ave, MC 2050
Chicago, IL 60637
773-834-0358
scollins4@uchicago.edu

Pleas Copas, MD**1999**

1932 Alcoa Hwy #150
Knoxville, TN 37920
pcopas@wc-grp.com

— Membership Roster —

Jeffrey L. Cornella, MD**1995**

5777 East Mayo Blvd.
Phoenix, AZ 85054
cornella.jeffrey@mayo.edu

Marlene Corton, MD**2011**

5323 Harry Hines Boulevard
Dallas, TX 75390
214-648-6430
marlene.corton@utsouthwestern.edu

Bruce S. Crawford, MD**2009**

645 Sierra Rose Dr. Suite 204
Reno, NV 89511
775 250-0267
pf171@live.com

Catrina Crisp, MD**2016**

3219 Clifton Avenue
Cincinnati, OH 45220
513-862-4171
catrina_crisp@trihealth.com

Andrew Croak, DO**2014**

625 Gibbs Street
Maumee, OH 43537
419-878-8080
acroak@nwourogyn.com

Stephen H. Cruikshank, MD**1989**

Chair Emeritus
Maineville, OH 45039
shcbmc@aol.com

Patrick Culligan, MD**2003**

435 South Street, Ste. 370
Morristown, NJ 7960
patrick.culligan@mybladderMD.com

Geoffrey W. Cundiff, MD**1998**

University of British Columbia/Dept.
OB/GYN
Vancouver, BC, Canada 0
604-806-9966
geoff.cundiff@gmail.com

Vani Dandolu, MD**2007**

2040 West Charleston Blvd.
Las Vegas, NV 89102
vdandolu@medicine.nevada.edu

John O.L. DeLancey, MD**1986**

Room L4100 WH 1500 E. Medical
Ctr. Dr.
Ann Arbor, MI 48109
734-647-5866
delancey@umich.edu

Michael Diamond, MD**1990**

1120 15th St., BA-7300
Augusta, GA 30912
706-721-3591
Michael.Diamond@gru.edu

Nicole Donnellan, MD**2016**

300 Halket Street
Pittsburgh, PA 15213
412-341-1432
donnellann2@upmc.edu

Sean C. Dowdy, MD**2009**

Mayo Clinic 200 First Street, SW
Rochester, MN 55905
507-266-0225
dowdy.sean@mayo.edu

— Membership Roster —

Peter Drewes, MD**2007**

585 North 500 West
Provo, UT 84601
801-374-1801
drewes@valleyobgynutah.com

Harold P. Drutz, MD**1996**

Ontario Power Generation Bldg.
700 University Ave., Room 8-815
Toronto, Ontario, ON 0
416-586 4642
hdrutz@mtsinai.on.ca

Gena Dunivan, MD**2013**

MSC10-5580 1 University of New
Mexico
Albuquerque, NM 87131
505-272-9712
gdunivan@salud.unm.edu

Terry S. Dunn, MD**2009**

850 E. Harvard Ave. Suite#285
Denver, CO 80210
303-653-6752
tdunnmd@urogyns.com

Thinh H. Duong, MD**2009**

No current address
thdmd@yahoo.com

Karolynn Echols, MD**2016**

6012 Piazza @ Main
Voorhees, NJ 8043
856-325-6622
karolynnechols@gmail.com

Renee Edwards, MD**2003**

3181 SW Sam Jackson Park RD
Mailcode L466
Portland, OR 97239
edwardre@ohsu.edu

Eman Elkadry, MD**2004**

725 Concord Avenue
Cambridge, MA 2138
eelkadry@mah.harvard.edu

Mark Ellerkmann, MD**2016**

227 St. Paul Place
Baltimore, MD 21202
443-275-5050
mellerkm@mdmercy.com

Denise Elser, MD**2001**

5851 W. 95th St., Suite 300
Oaklawn, IL 60453
708-499-9800
delsel@whii.org

Elisabeth Erikson, MD**2013**

1 Medical Center Drive
Lebanon, NH 3766
603 653-9312
Elisabeth.A.Erikson@hitchcock.org

John Fantl, MD**Charter**

Mount Sinai- Beth Israel Medical
System
New York, NY 10003
631 277 6619
fantlja1@gmail.com

— Membership Roster —

**Tola Fashokun, MD
2015**

4940 Eastern Avenue
Baltimore, MD 21224
410-550-2787
tfashok1@jhmi.edu

**Abdalla Fayyad, MD
2013**

Lewsey Road
Luton, UK 0
amfayyad@gmail.com

**Atif Fazari, MD, MPH
2014**

UMST- Sudan
Khartoum, Sudan 11111
atiffazari@hotmail.co.uk

**Dee E. Fenner, MD
1995**

1500 F. Medical Ctr., Dr., L4000
Women's Hosp
Ann Arbor, MI 48109
deef@umich.edu

**Paul Fine, MD
2009**

5121 Oak Court
Dickinson, TX 77539
paul.fine@ppgulfcoast.org

**Robert Flora, MD
2015**

16001 W 9 Mile Road
Southfield, MI 48075
330-342-4543
robert.flora@stjohn.org

**Raymond Foster, MD
2014**

500 N. Keene St. Ste 306
Columbia, MO 65201
573-999-3268
fosterrt@health.missouri.edu

**Sean Francis, MD
2016**

401 E. Chestnut St., Ste 470
Louisville, KY 40202
502-561-7441
seanf000@gmail.com

**Arnold J. Friedman, MD
1988**

350 East 17th St. 8th Floor
New York, NY 10003
afriedma@chpnet.org

**Rajiv Gala, MD
2009**

4429 Clara Street Mc Farland
Medical Plaza; Suite 440
New Orleans, LA 70115
504-842-6680
rgala@ochsner.org

**John Gebhart, MD
2006**

Mayo Clinic - OB/GYN
Rochester, MN 55905
507-266-7711
gebhart.john@mayo.edu

**Liz Geller, MD
2014**

CB 7570 Old Clinic
Chapel Hill, NC 27599
egeller@med.unc.edu

**Rene Genadry, MD
1992**

200 Hawkins Dr. 51233 PFP
Iowa City, IA 52242
rene-genadry@uiowa.edu

**Mohamed Ghafar, MD
2014**

9 Roseanne
Woodbury, NY 11797
646-508-9166
mghafar2@gmail.com

— **Membership Roster** —

Dobie Giles, MD

2015

600 Highland Ave, H4/630 CSC,
Box 6188
Madison, WI 53792
giles2@wisc.edu

Elliot Greenberg, MD

2015

50 Union St
West Springfield, MA 1087
413-794-1599
elliottgreenbergmd@gmail.com

Cara Grimes, MD

2016

622 West 168th Street
New York, NY 10032
646-342-1315
clg2173@columbia.edu

Daniel Gruber, MD

2013

11815 Prestwick Rd.
Potomac, MD 20854
ddgruber1@gmail.com

Robert Gutman, MD

2009

106 Irving St NW, Suite 405 S
Washington, DC 20010
202-877-6526
Robert.E.Gutman@medstar.net

Douglass Hale, MD

2006

1633 N. Capitol Avenue
Indianapolis, IN 46202
317-962-6600
dhale@iuhealth.org

Brittany Star Hampton, MD

2009

101 Plain Street
Providence, RI 2903
bhampton@wihri.org

Charles Hanes, MD

2006

3 Mobile Infirmary Circle, Suite 401
Mobile, AL 36607
hanes@urogynsa.com

Gerald Harkins, MD

2016

500 University Dr. PO Box 850,
H103
Hershey, PA 17033
717-645-0597
gharkins@hmc.psu.edu

Oz Harmanli, MD

2004

759 Chestnut St., S-1681
Springfield, MA 1199
413-794-5608
oz.harmanli@bhs.org

Wesley J. Harris, MD

2000

Bristol GYN and OB
Bristol, TN 37620
ickharris1@gmail.com

Robert Harris, MD

2003

501 Marshall St.
Jackson, MS 39202
rharris@seug.com

Christine Heisler, MD

2012

25 Michigan Ste NE Ste. 6200
Grand Rapids, MI 49503
christine.heisler@spectrum-
health.org

Michael Heit, MD

2000

1633 N Capitol Ave
Carmel, IN 46032
mheitmd@gmail.com

— **Membership Roster** —

Wesley Hilger, MD

2009

2801 K St #200
Sacramento, CA 95816
916 779-1160
whilger@hotmail.com

Robert L. Holley, MD

2001

P.O. Box 59707
Birmingham, AL 35259
none
pilut0713@gmail.com

Adam Holzberg, DO

2010

6012 Main Street
Voorhees, NJ 8043
856-326-6622
adholzberg@gmail.com

Michael Hopkins, MD

1999

2600 Tuscarawas St. #420 W.
Canton, OH 44708
michael.hopkins@aaltman.com

Nicolette S. Horbach, MD

1997

NorthernVirginia Pelvic Assn.
Annandale, VA 22003
nhorbach@aol.com

Ira R. Horowitz, MD

1995

1639 Pierce Dr., Room 4307
Atlanta, GA 30322
ihorowi@emory.edu

Denise Howard, MD

2005

PO Box 26999
Doha, Qatar 0
119744404-2168
drdenhow@gmail.com

Lennox Hoyte, MD

2006

3225 S. Macdill Ave, #129-307
Tampa, FL 33629
lennox@mindspring.com

Yvonne Hsu, MD

2010

OB/GYN 30 North 1900 East,
Room 2B 200
Salt Lake City, UT 84132
yvonne.hsu@hsc.utah.edu

Hye-Chun Hur, MD, MPH

2016

330 Brookline Ave
Boston, MA 2215
617-667-4030
hhur@bidmc.harvard.edu

William W. Hurd, MD

1995

5704 Fayetteville Rd
Durham, NC 27713
191-573-4673
William.hurd@duke.edu

Cheryl Iglesia, MD

2008

106 Irving Street, NW, Suite 405
South
Washington, DC 20010
202-877-6526
cheryl.iglesia@medstar.net

Peter Jeppson, MD

/2016

2211 Lomas Blvd NE 4th Floor
Albuquerque, NM 87131
peterjeppson@gmail.com

Lisa Johnson, MD

2016

5851 W. 95th St., Suite 300
Oak Lawn, IL 60453
708-499-9800
LCLabin@hotmail.com

— **Membership Roster** —

Margie Kahn, MD

2006

Dept. OB/GYN
New Orleans, LA 70112
margiekahn@msn.com

Dorothy N. Kammerer-Doak, MD

1999

4705 Montgomery Blvd. NE
Suite 201
Albuquerque, NM 87109
dkd@womenspsc.com

Sarah Kane, MD

2015

4121 Dutchman's LN, Suite 307
Louisville, KY 40207
502-409-5600
skaneliu@yahoo.com

Mickey M. Karram, MD

1993

The Christ Hospital
Cincinnati, OH 45219
Mickey.Karram@thechristhospital.com

Sesh Kasturi, MD

2015

2801 K Street
Sacramento, CA 95816
916-779-1166
seshkasturi@yahoo.com

Kristinell Keil, MD

2007

4500 East 9th Avenue #420
Denver, CO 80220
303-329-5822
kky@keilurogynecology.com

Kimberly Kenton, MD

2005

Dept. OB/GYN 250 East Superior
Chicago, IL 60611
kkenton@nm.org

Rosanne Kho, MD

2015

9500 Euclid Ave
Cleveland, OH 44116
216 444 -6337
sahnmd@gmail.com

Cara King, DO

2016

600 Highland Avenue
Madison, WI 53792
608-263-6408
cararobinsonking@gmail.com

Steven D. Kleeman, MD

2007

3219 Clifton
Cincinnati, OH 54220
513-862-4171
steven_kleeman@trihealth.com

John V. Knaus, DO

1993

5747 W. Dempster, Suite 100
Morton Grove, IL 60053
jknaus007@gmail.com

Yuko Komesu, MD

2009

Dept. OB/GYN 2211 Lomas Blvd.,
NE
Albuquerque, NM 87131
ykomesu@salud.unm.edu

Abner P. Korn, MD

2003

1001 Potrero Ave, Rm 6D-17
San Francisco, CA 94110
korna@obgyn.ucsf.edu

Bela Kudish, MD

2014

2415 N. Orange Ave
Orlando, FL 32804
407-303-1380
belakudish@gmail.com

— **Membership Roster** —

Wilma Larsen, MD
2005

2001 S. 31st St.
Temple, TX 76508
254-724-5872
wilma.larsen@BSWHealth.org

Christine LaSala, MD
2008

Hartford Hospital 85 Seymour St.,
Suite 525
Hartford, CT 6106
860 972-4338
christine.lasala@hhchealth.org

Ted Lee, MD
2009

300 Halket Street
Pittsburgh, PA 15213
412-641-4245
tlee@mail.magee.edu

Gretchen Lentz, MD
2006

Dept. OB/GYN BB-644 HSC Box
356460
Seattle, WA 98195
gretchen@u.washington.edu

Barbara Levy, MD
2014

409 12th Street, SW
Washington, DC 20024
blevy@acog.org

Christina Lewicky-Gaupp, MD
1/1/2015

676 N. St. Clair
Chicago, IL 60611
cgaupp@nmff.org

Janet Li, MD
2016

330 Brookline Ave. 3rd Flr.
Boston, MA 2215
jli10@bidmc.harvard.edu

Frank Ling, MD
1993

Women's Health Specialists
Germantown, TN 38138
fling@whsobbgyn.com

Gary H. Lipscomb, MD
1993

1301 Primacy Parkway
Memphis, TN 38119
garyhlipscomb@gmail.com

Robert W. Lobel, MD
1999

5 Palisades Dr., Suite 220
Albany, NY 12205
rwlobel@aol.com

Ernest G. Lockrow, DO
2003

4608 Saul Road
Kensington, MD 20895
301-295-2270
elockrow@aol.com

Jaime Long, MD
2013

301 S. 7th Ave., Suite 1020
West Reading, PA 19611
jaime.long@readinghospital.org

Vincent R. Lucente, MD
1998

The Institute for Female Pelvic
Medicine
Allentown, PA 18104
vlucente@fpminstitute.com

Paul Magtibay, MD
2006

5779 E. Mayo Blvd. 3rd Floor
Phoenix, AZ 85054
480-342-2499
magtibay.paul@mayo.edu

— Membership Roster —

**Sangeeta Mahajan, MD
2011**

Univ. Hospital of Cleveland
Cleveland, OH 44106
stm9898@gmail.com

**Saifuddin Mama, MD, MPH
2015**

3 Cooper Plaza, Suite 221
Camden, NJ 8103
856-342-3006
mama-saifuddin@cooperhealth.edu

**Mamta Mamik, MD
2015**

1176 5th Ave
New York, NY 10029
mamta.mamik@gmail.com

**Jeffrey Mangel, MD
2011**

Metrohealth Medical Center
Cleveland, OH 44109
jmangel@metrohealth.org

**Rebecca Margulies, MD
2016**

275 West MacArthur Blvd
Oakland, CA 94611
510-859-5370
rebecca.margulies@gmail.com

**Arnulfo Martinez, MD
2014**

Av. Hidalgo 2425-903
Monterrey, Mexico 64060
81 84785383
amch@cmhidalgo.com

**Kristen Matteson, MD
2013**

101 Dudley Street
Providence, RI 2905
401-274-1122
kmatteson@wihri.org

**Catherine Matthews, MD
2011**

1 Medical Center Blvd.
Winston-Salem, NC 27157
336-716-4310
camatthe@wakehealth.edu

**George B. McClure, MD
2003**

MultiCare Health Systems
Lakewood, WA 98499
georgebmc@comcast.net

**Anna McNanley, MD
2015**

9855 Hospital Drive
Maple Grove, MN 55369
mcna@mac.com

**S. Gene McNeeley, MD
1998**

44555 Woodward Avenue Suite
402
Pontiac, MI 48341
Betsy.Shaker@stjoeshealth.org

**Carlos Medina, MD
2000**

Holtz Center 7007, 6885 Cassis
Place
Miami, FL 33164
cmedina@med.miami.edu

**Shawn Menefee, MD
2011**

3250 Fordham street
San Diego, CA 92120
619-221-6398
menefeekp@gmail.com

**Stephen Metz, MD
1997**

171 Coventry Lane
Longmeadow, MA 1106
413-567-8697
smetz@massmed.org

— Membership Roster —

John R. Miklos, MD**2003**

3400-C Old Milton Pkwy. #330
Alpharetta, GA 30005
johnrmiklos@yahoo.com

Douglas Miyazaki, MD**2015**

114 Charlois Blvd
winston salem, NC 27103
330-765-5470
dm@miyazakienterprises.com

Michael Moen, MD**2003**

1875 Dempster Street
Park Ridge, IL 60068
847-825-1590
michael.moen@advocatehealth.com

Stephanie Molden, MD**2012**

760 Newtown Yardley RD, Suite
115
Newtown, PA 18940
215-860-2454
smolden@fphcenter.com

Michelle Morrill, MD**2016**

2238 Geary Blvd, 7SW
San Francisco, CA 94115
415-948-4896
mymorrill@gmail.com

Abraham Morse, MD, MBA**2003**

70 Walnut Street
Wellesley, MA 2481
anmorse@bostonurogyn.com

Tyler Muffly, MD**2015**

12361 E 17th Ave
Aurora, CO 80045
tyler.muffly@ucdenver.edu

Miles Murphy, MD**2008**

Institute for Female Pelvic Medicine
North Wales, PA 19454
milesmurphy@comcast.net

Deborah Myers, MD**2000**

695 Eddy Street
Providence, RI 2903
dmyers@wihri.org

Charles Nager, MD**2005**

200 W. Arbor Dr. #8433
San Diego, CA 92103
cnager@ucsd.edu

Mikio A. Nihira, MD**2005**

920 Stanton L. Young
Oklahoma City, OK 73104
405 271 9493
mikio-nihira@ouhsc.edu

Michael Noone, MD**2009**

1875 Dempster St., Suite 665
Park Ridge, IL 60068
847-825-1590
michael.noone@advocatehealth.com

Gina Northington, MD**2016**

1639 Pierce Dr. WMB Room #4307
Atlanta, GA 30322
404-727-8600
gina.northington@emory.edu

Peggy Norton, MD**1993**

Dept. OB/GYN 30 North 1900 East
Salt Lake City, UT 84132
peggy.norton@hsc.utah.edu

— **Membership Roster** —

Amy O'Boyle, MD
2010
8037 Park Lane
Bethesda, MD 20814
301-654-5756
amyoboyle@aol.com

John Occhino, MD
2016
200 First Street SW
Rochester, MN 55905
507-266-7711
Occhino.John@mayo.edu

Cedric Olivera, MD
2013
8714 5th Avenue
Brooklyn, NY 11209
cedric.olivera@nyumc.org

Francisco Orejuela, MD
2012
One Baylor Plaza
Houston, TX 77030
Francisco.Orejuela@bcm.edu

James Orr, Jr., MD
1986
8931 Colonial Center Dr.
Fort Myers, FL 33905
jorr@rtsx.com

Lesley Otto, MD
2003
9155 SW Barnes Rd. Suite 634
Portland, OR 97225
lotto@orclinic.com

Marie Fidela Paraiso, MD
2003
The Cleveland Clinic Foundation
Cleveland, OH 44195
paraism@ccf.org

Amy Park, MD
2013
106 Irving St NW, Suite 405 S
Washington, DC 20010
202-877-6151
parkamy@gmail.com

Danielle Patterson, MD
2014
800 Washington Street #232
Boston, MA 2111
617-636-5890
dpatterson1@tuftsmedicalcenter.org

Rachel Pauls, MD
2014
3219 Clifton Ave. Ste 100
Cincinnati, OH 45220
513-405-4581
Rachel_Pauls@trihealth.com

Lisa M. Peacock MD, MD
1998
1542 Tulane Avenue, 5th Floor
New Orleans, LA 70112
504-568-8663
lpeac1@lsuhsc.edu

Manuel A. Penalver, MD
1989
5000 University Dr.
Coral Gables, FL 33146
mannypenalver@aol.com

Paul Pettit, MD
2000
4500 San Pablo Road 2W
Cannaday
Jacksonville, FL 32224
904 9532977
paul.pettit@mayo.edu

— Membership Roster —

**Joseph F. Pohl, MD
1997**

500 Medical Center Blvd. Suite 365
Lawrenceville, GA 30045
jpohls@comcast.net

**David Quinlan, MD
2014**

101 - 1964 Fort Street
Victoria, BC 0
davidjquinlan@shaw.ca

**Gregory Raff, MD
2013**

1481 W. 10th St
Indianapolis, IN 46202
317-850-1262
giraff@iupui.edu

**David Rahn, MD
2011**

5323 Harry Hines Blvd.
Dallas, TX 0
david.rahn@utsouthwestern.edu

**George Ralph, MD
2004**

LKH Leoben 8700 Leoben
Leoben, Austria 8700
george.ralph@lkh-leoben.at

**Olga Ramm, MD
2016**

3779 Piedmont Ave, 1st Floor
Oakland, CA 94611
510-752-8215
olgaramm@gmail.com

**Charles R. Rardin, MD
2009**

101 Plain Street 5th floor
Providence, RI 2905
crardin@wihri.org

**Monica Richardson, MD
2016**

250 Hospital Parkway
San Jose, CA 95119
408-362-3718
monica.richardson@kp.org

**Holly E. Richter, PhD, MD
2004**

1700 6th AV South, Suite 10382
Birmingham, AL 35233
hrichter@uabmc.edu

**Beri Ridgeway, MD
2016**

14350-2 Meridian Parkway
Riverside, CA 92521
951.827.7582
beri.ridgeway@medsch.ucr.edu

**John W. Riggs, MD
2004**

5656 Kelley
Houston, TX 77026
713-5665041
john.w.riggs@uth.tmc.edu

**Paul A. Riss, MD
2008**

Anna Frauer Gasse 2
1180 Vienna, Austria
paul.riss@gmail.com

**Carla P. Roberts, MD
2001**

1800 Northside Forsyth Dr., Suite
380
Cumming, GA 30041
770-292-2670
amanda.brown2@northside.com

**Marcella L. Roenneburg, MD
2004**

Eastern Shore OB/Gyn
Salisbury, MD 21804
atlasofpelvicsurgery@gmail.com

— Membership Roster —

Robert M. Rogers, MD

1995

Kalispell Regional Medical Center
Kalispell, MT 59901
shirdoc@aol.com

Rebecca Rogers, MD

2001

Dept. of OB/GYN, MSC 10 5580 1
Albuquerque, NM 87131
rrogers@salud.unm.edu

Audrey Romero, MD

2016

101 Old Short Hills Road
West Orange, NJ 7052
919-451-5335
romeroaudrey@hotmail.com

Peter Rosenblatt, MD

2004

725 Concord Ave., Suite 1200
Cambridge, MA 2465
plrosen@comcast.net

Norman G. Rosenblum, MD

1991

830 Primrose Lane
Wynnewood, PA 19096
norman.rosenblum@jefferson.edu

Jim W. Ross, MD

2003

505 E. Romie Lane, Suite D
Salinas, CA 93901
831-754-2238
crmfc2012@gmail.com

Tatiana Sanses, MD

2013

22nd S Greene Street
Baltimore, MD 21201
tsanses@fpi.umaryland.edu

Joseph Schaffer, MD

2001

Dept. OB/GYN 5323 Harry Hines
Blvd.
Dallas, TX 75390
214-648-7211
joseph.schaffer@utsouthwestern.edu

Megan Schimpf, MD

2012

1500 E. Medical Center Dr. L4100
Ann Arbor, MI 48109
734-647-5866
mschimpf@umich.edu

Mitchell Schuster, MD

2012

1874 Beltline Rd, Suite 105
Decatur, AL 35601
256-340-9996
decobgyn@bellsouth.net

Jonathan Shepherd, MD

2016

300 Halket St., Suite 5600
Pittsburgh, PA 15213
412-926-5175
dr.jon.shepherd@gmail.com

S. Abbas Shobeiri, MD

2009

W6306, 3300 Gallows Rd
Falls Church, VA 22042
abbas.shobeiri@inova.org

Bob Shull, MD

1988

Dept. OB/GYN 2401 S. 31st Street
Tempe, TX 76508
254 724 5872
bshull@sw.org

— **Membership Roster** —

David Shveiky, MD

2015

Department of Ob/Gyn, Hadassah
Med. Ctr.
Jerusalem, Israel 12000
dshveiky@gmail.com

Nazanin Silver, MD

2014

1130 Hwy 315
Wilkse-Barre, PA 18702
646-341-2011
nazy30@gmail.com

Ambereen Sleemi, MD, MPH

2014

22 Prospect Park SW
Brooklyn, NY 11215
917-324-8348
osleemi@yahoo.com

Scott W. Smilen, MD

1999

150 East 32nd Street 2nd floor
New York, NY 10016
scott.smilen@nyumc.org

Eric Sokol, MD

2014

300 Pasteur Drive, Room G302A
Stanford, CA 94305
esokol@stanford.edu

Andrew Sokol, MD

2011

106 Irving St., NW
Washington, DC 20010
202-877-6526
asokol72@gmail.com

John W. Spurlock, MD

1997

433 E. Broad St., Unit 1
Bethlehem, PA 18018
jonthebold@aol.com

Edward Stanford, MD

2004

1441 Florida Ave
Modesto, CA 95360
209-576-3553
edward.stanford@tenethealth.com

Adam Steinberg, DO

2009

1832 Asylum Ave.
West Hartford, CT 6117
acsteinberg06@yahoo.com

Thomas G. Stovall, MD

1991

7800 Wolf Trail Cove
Germantown, TN 38138
tstovall@whsobbgyn.com

Kris Strohhahn, MD

2003

Dartmouth-Hitchcock Medical
Center
Lebanon, NH 3768
603-653-9312
kris.strohhahn@hitchcock.org

Joe T Stubbs, MD

2008

5356 Reynolds Street Suite 301
Savannah, GA 31405
stubbs@urogynsavannah.com

Carmen Sultana, MD

2011

243 E. 149th St., Room 518
Bronx, NY 10451
carmensultana@comcast.net

Robert L. Summitt, MD

1994

Women's Health Specialists
Germantown, TN 38138
rsummitt@whsobbgyn.com

— **Membership Roster** —

Vivian Sung, MD

2009

101 Plain Street, 5th Floor
Providence, RI 2903
vsung@wihri.org

Gary Sutkin, MD

2016

300 Halkert St., Room 2327
Pittsburgh, PA 15213
gsutkin@magee.edu

Karl F. Tamussino, MD

1999

Dept. OB/GYN
Auenbruggerplatz 14
A-8036 Graz, Austria 8036
karl.tamussino@medunigraz.at

James Theofrastous, MD

2000

Western Carolina Women's
Specialty Center
Asheville, NC 28806
theo1@wcwsc.com

Jason Thompson, MD

2004

Florida Urogynecology and
Reconstructive Pelvic Surgery
Jacksonville, FL 32216
jthompson@flurogyn.com

Marc Toglia, MD

2004

Suite 3404, HealthCare Center 3
1098 W. Baltimore Pike
Media, PA 19063
610-627-4170
togliam@verizon.net

Paul Tulikangas, MD

2008

Hartford Hospital/University of
Connecticut
Hartford, CT 6106
paul.tulikangas@hhchealth.org

Elena Tunitsky-Bitton, MD

2016

85 Seymour St.
Hartford, CT 6106
860-972-4338
lena0605@gmail.com

Christine Vaccaro, DO

2011

ATTN: MCHJ-CLG-U
Tacoma, WA 98431
253-861-7455
vaccaro.christine@gmail.com

Heather van Raalte, MD

2013

10 Forrestal Road South, Suite 205
Princeton, NJ 8540
vanraalte@princetonurogyn.com

R. Edward Varner, MD

1988

OB/GYN 1700 6th Ave. South,
#10382
Birmingham, AL 35233
evarner@uabmc.edu

Brett Vassallo, MD

2008

1875 Dempster St., Suite 665
Park Ridge, IL 60068
847 825 1590
bvassallo@comcast.net

Dionysios K. Veronikis, MD

1999

621 S. New Ballas Rd.
Suite 2002-B
St. Louis, MO 63141
314-251-6753
dveronikis@stlgynsurgery.com

— **Membership Roster** —

Anthony G. Visco, MD

2008

Dept. OB/GYN 245 Baker House,
Trent Dr.
Durham, NC 27715
anthony.visco@duke.edu

Cliff Wai, MD

2013

5323 Harry Hines Blvd.
Dallas, TX 75390
214-648-6430
clifford.wai@utsouthwestern.edu

Stacey Wallach, MD

2016

4860 Y St. Suite 2500acc
Sacramento, CA 95817
916-734-6900
sjwallach@ucdavis.edu

Christopher Walshe, MD

2003

5838 Harbour View Blvd.
Suffolk, VA 23435
cjwalshe@msn.com

Andrew J. Walter, MD

2001

TPMG
Roseville, CA 95661
916.447.5809
andrew.j.walter@kp.org

Mark D. Walters, MD

1990

9500 Euclid Ave., Desk A81
Cleveland, OH 44195
216- 445-6586
walterm@ccf.org

Renee Ward, MD

2014

1162 21st Avenue South
Nashville, TN 37232
615-322-8968
renee.ward@vanderbilt.edu

Blair Washington, MD

2014

1100 Ninth Avenue
Seattle, WA 98101
206-223-6191
blairwashington1@gmail.com

Emily Weber LeBrun, MD

2014

1600 SW Archer Road
Gainesville, FL 32610
352-318-4888
eweber@ufl.edu

Alison C. Weidner, MD

2005

5324 McFarland Dr Suite 310
Durham, NC 27707
weidn001@mc.duke.edu

Thomas Wheeler, II, MD

2009

890 W. Faris Rd.
Greenville, SC 29605
864-293-6418
twheeler@ghs.org

Terry White, MD

2016

1411 E. 31st Street
Oakland, CA 94602
t_white17@yahoo.com

— **Membership Roster** —

James Whiteside, MD

2014

11135 Grandstone Lane
Cincinnati, OH 45249
whitesje@ucmail.uc.edu

Anne K. Wiskind, MD

1995

1800 Peachtree St., NW
Atlanta, GA 30309
awiskind@gmail.com

Patrick J. Woodman, DO

2009

16001 West 9-Mile Rd., 3rd Floor
Southfield, MI 48075
248-849-6030
Patrick.Woodman@gmail.com

Carl Zimmerman, MD

2000

Vanderbilt Univ. School of Medicine
Nashville, TN 37232
615-322-8968
cwzimmer@aol.com

— *Life Members* —

G. David Adamson, MD
1994
20665 Fourth Street, Suite 201
Saratoga, CA 95070

W. Allen Addison, MD
Charter
PO Box 727
Hillsborough, NC 27278

William S. Alford, DO
2003
4804 Bridlewood cr ne
Canton, OH 44714

Lester A. Ballard, MD
1995
36000 Fairmount Blvd.
Hunting Valley, OH 44022

James G. Blythe, MD
Charter
231 Northwind Dr.
Brandon, MS 39047

John W. Boldt, MD
Charter
7703 Floyd Curl Drive
San Antonio, TX 78229

Edwin A. Bowman, MD
1988
515 Holly Point Road
Freeport, FL 32439

Mark Boyd, MD
1991
Greene Avenue Clinic
Montreal, Canada H3Z2A4

James L. Breen, MD
Charter
14 N. Calibogue Cay
Hilton Head Island, SC 29928

David S. Chapin, MD
1997
310 Hammond Pond Parkway
Chestnut Hill, MA 02467

Stephen A. Cohen, MD
Charter
PO Box 980034
Richmond, VA 23298

Joseph A. DeCenzo, MD
Charter
10651 SW 77 Ave.
Miami, FL 33156

Bruce H. Drukker, MD
Charter
18242 Lost Creek Lane
Spring Lake, MI 49456

Leo J. Dunn, MD
Charter
PO Box 34, MCV Station
Richmond, VA 23298

Paul B. Edmonds, MD
Charter
18315 Salvador Rd.
Edmond, OK 73012

Robert R. Franklin, MD
1989
Obstetrical & Gynecological Assoc.
Houston, TX 77054

Melvin V. Gerbie, MD
1989
Northwestern University Medical
School
Chicago, IL 60610

Gerald Glowacki, MD
1997
11210 Old Carriage Road
Glen Arm, MD 21057

— *Life Members* —

Frank C. Greiss, MD
Charter

518 Stonemarker Road
Mooresville, NC 28115

Robert Hebertson, MD
Charter

988 Eagle Way
North Salt Lake, UT 84054

Patrick Hogston, MD
2003

11 Brading Ave.
SOUTHSEA, Hampshire, UK PO4
9QJ

William J. Hoskins, MD
1988

New York, NY 10021

Harvey T. Huddleston, MD
1995

Big Bend Regional Medical Center
Alpine, IN 79830

W. Glenn Hurt, MD
1997

1500 Westbrook Court, Apt. 1143
Richmond, VA 23227

Frederick W. Jelovsek, MD
1992

3520 Homewood Dr.
Johnson City, TN 37604

Van Jenkins, MD
1997

2980 Four Pines Dr #4
Lexington, KY 40502

Thomas Julian, MD
1992

4892 Foxfire Trail
Middleton, WI 53562

Alan L. Kaplan, MD
1988

6550 Fannin, Suite 901-A
Houston, TX 77030

Ernest I. Kohorn, MD
1985

820 Oakwood Road, FMB322
ORANGE, CT 06477

S. Robert Kovac, MD
1987

Dept. GYN/OB 415 55th Ave
St. Pete Beach, FL 33706

Philip J. Krupp, MD
1986

#6 Swan St.
New Orleans, LA 70124

Eberhard C. Lotze, MD
1987

9333 Memorial Drive, # 105
Houston, TX 77024

Robert Maier, MD
1989

UT Houston Medical School
Houston, TX 77026

L. Russell Malinak, MD
Charter

9777 Sawmill Rd.
Brenham, TX 77833

Byron J. Masterson, MD
1987

5121 Hidden Harbor Road
Sarasota, FL 34242

Edwin S. McClain, MD
Charter

2015 Barrel Racer Lane
Carmel, IN 46032

— *Life Members* —

C. Frank McDonell, Jr, MD
Charter
210 13th Avenue Place NW
Hickory, NC 28601

Frederick W. McLean, MD
1996
Dept. OB/GYN PO Box 100294
Gainesville, FL 32610

G. Rodney Meeks, MD
1989
207 Audubon Point Dr.
Brandon, MS 39047

Fred S. Miyazaki, MD
1997
5333 Encino Ave.
Encino, CA 91316

John F. Moffett, MD
Charter
2610 E. Levingwood Rd.
Lake Charles, LA 70611

Ana A. Murphy, MD
1993
1120 15th Street, BA 7300
Augusta, GA 30912

Jonathan M. Niloff, MD
1991
Harvard Medical School
West Newton, MA 02465

Thomas E. Nolan, MD
1992
403 Pinecrest
Davidson, NC 28036

Karl C. Podratz, MD
1986
Mayo Clinic
Rochester, MN 55905

Charles Portera, MD
1989
721 Glenwood Dr. 560-W
Chattanooga, TN 37404

Konald A. Prem, MD
Charter
15660 16 Place N.
Plymouth, MN 55447

Brooks Ranney, MD
Charter
Dept. OB/GYN Box 590
Yankton, SD 57078

Jack R. Robertson, MD
Founding
1451 N. Refugio Road
Santa Ynez, CA 93460

John A. Rock, MD
1987
11200 SW 8th St, HLS 693
Miami, FL 33199

Robert E. Rogers, MD
Charter
11065 Spice Lane
Fishers, IN 46038

George T. Schneider, MD
Charter
Oshsner Medical Institutions
New Orleans, LA 70121

Richard H Schwarz, MD
Charter
57 Green Meadow Lane
Huntington, NY 11743

Joseph C. Scott, MD
1987
1502 South 113 Plaza
Omaha, NE 68144

— *Life Members* —

George L. Sexton, MD
1990
223 Springmont Dr.
Wyomissing, PA 19610

C. Robert Stanhope, MD
Charter
Dept. OB/GYN 200 1st St, SW
Rochester, MN 55905

Keith Stone, MD
1988
1600 SW Archer Rd. PO Box
100294
Gainesville, FL 32610

O. Eduardo Talledo, MD
1990
1120 15th Street, Suite BB 7513
Augusta, GA 30912

Robert J. Thompson, MD
1990
8691 San Servera Dr., West
Jacksonville, FL 32217

John D. Thompson, MD
Charter
Dept. OB/GYN
Chestnut Mountain, GA 30502

Peter K. Thompson, MD
1995
7550 Fannin
Houston, TX 77054

M. Chrystie Timmons, MD
1990
GERIGYN, PA
Chapel Hill, NC 27517

Daniel A. Triplett, MD
Charter
936 Scott Dr
Liberty, MO 64068

Tom Walker, MD
Charter
602 W. Zenith
Temple, TX 76501

L. Lewis Wall, MD, PhD
1996
One Brookings Dr., Campus Box
1114
St. Louis, MO 63130-4899

Anne M. Weber, MD
1998
NICHD
Pittsburg, PA 15238

Sheldon Weinstein, MD
Charter
8160 Walnut Hill Lane Suite 100
Dallas, TX 75231

Clifford R. Wheeless, MD
1994
6132 Allwood Court Apt213
Baltimore, MD 21210

Tiffany J. Williams, MD
Charter
6550 Manasota Key Road
Englwood, FL 34223

Arthur C. Wittich, DO
2001
COL, MC, USA
Lorton, VA 22079

Stephen B. Young, MD
1995
University of Massachusetts
Princeton, MA 01541

— Associate Members —

Melinda Abernethy, MD
4940 Eastern Ave, 301 Building,
3rd Floor
Baltimore, MD 21224
410-550-2787
maberne1@jhmi.edu

Sonia Adams, MD
736 Cambridge Street
Brighton, MA 2135
617-354-5452
sonia.adams@steward.org

Amos Adelowo, MD
641 North Avenue NE
Atlanta, GA 30308
504-319-4915
amosadelowo@gmail.com

Fabiola Balmir, MD
300 Halket St
Pittsburgh, PA 15213
balmirf@upmc.edu

Heather Barbier, MD
620 Paul Jones Circle
Portsmouth, VA 23708
hbarbier@mac.com

Benjamin Barenberg, MD
825 NE 10th Street, Suite 5300
Oklahoma City, OK 73104
405-271-9493
benjamin-barenberg@ouhsc.edu

Rachel Barr Grzesh, MD
115 E. 23rd St, 10th Floor
New York, NY 10010
212-982-8383
rachel.lynn.barr@gmail.com

Kenneth Barron, MD
2415 N Orange Ave., Ste 300
Orlando, FL 32804
407-303-2780
kenneth.barron.md@gmail.com

Heidi Brown, MD
600 Highland Avenue, Box 6188
Madison, WI 53792
608-265-5664
heidi.brown@gmail.com

Kristina Butler, MD
5777 East Mayo Blvd
Phoenix, AZ 85054
480-342-2000
butler.kristina@mayo.edu

Camille Calderwood, MD
3181 SW Sam Jackson Park Road
Portland, OR 97239
303-810-5481
calderca@ohsu.edu

Zaid Chaudhry, MD
10833 Le Conte Ave 27-139 CHS
Los Angeles, CA 90095
310-206-6558
zaidqchaudhry@gmail.com

Woojin Chong, MD
1176 Fifth Avenue - 9th floor
New York, NY 10029
212-241-7090
www.wojin@gmail.com

Gretchen Collins, MD
24107 E. Baintree Rd
Beachwood, OH 44122
630-992-2883
gg.garbe@gmail.com

Bhumy Dave, MD
250 E. Superior 05-2370
Chicago, IL 60611
312-472-3874
bhumydave@gmail.com

Laurephile Desrosiers, DO
1176 5th Ave
New York, NY 10029
212-241-1754
ldesrosi@gmail.com

— Associate Members —

Sybil Dessie, MD

725 Concord Ave, Suite 1200
Cambridge, MA 2138
617-354-5452
sdessie@mah.harvard.edu

Nicolette Deveneau, MD

550 S. Jackson St
Louisville, KY 40202
502-561-7260
ndeveneau@gmail.com

Mitch Dizon, MD

101 Manning Drive, Box 7570 Old
Clinic
Chapel Hill, NC 27599
919-843-9546
mitch_dizon@med.unc.edu

Omar Duenas, MD

119 Belmont Street
Worcester, MA 1655
508-334-85816
dugof1@hotmail.com

Aisha Elbareg, MD

PO Box 2472
Misurata, Libya
elbaregsm@hotmail.com

Rayan Elkattah, MD

522 E 5th St, Apt. 1
Chattanooga, TN 37403
423-778-2580
rayan_kattah@hotmail.com

David Ellington, MD

10382 Women's & Infants Center
1700 6th Av S
Birmingham, AL 35233
205-975-3587
davidelling@gmail.com

Sherif El-Nashar, MD, PhD

11100 Euclid Avenue
Cleveland, OH 0
216-844-3941
elnashar.sherif@gmail.com

Solafa Elshatanoufy, MD

300 Riverfront Dr, APT 17i
Detroit, MI 48226
609-741-7100
selshat1@hfhs.org

Elizabeth Evans, MD

7703 Floyd Curl Drive
San Antonio, TX 78229
casianoe@uthscsa.edu

Kristie Greene, MD

1365 Clifton Rd.
Atlanta, GA 30322
404-778-3401
kgree30@emory.edu

Meghan Griffin, DO

2079 W. Grand Blvd.
Detroit, MI 48202
313-916-2475
mgriffi3@hfhs.org

Karina Haber, MD

24 Hospital Ave. Danbury
Danbury, CT 6810
karinahaber@gmail.com

Lindsey Hahn, MD

2 Tampa General Circle
Tampa, FL 33606
813-844-8500
hahn.lindsey@gmail.com

Jennifer Hallock, MD

Bayview, 4940 Eastern Avenue,
301 Bldg.
Baltimore, MD 21224
410-550-9554
jhalloc1@jhmi.edu

Stephanie Henderson, MD

1111 E. McDowell Rd
Phoenix, AZ 85006
602-839-7601
Stephaniehenderson23@gmail.com

— Associate Members —

Audra Jo Hill, MD

9500 Euclid Avenue - A81
Cleveland, OH 44195
216-445-0439
jolynhill@gmail.com

Diego Illanes, MD

123 Summer Street, Suite 150
Worcester, MA 1608
508-368-3110
illanesd@gmail.com

Jana Illston, MD

1700 6th Ave S, Suite 10382
Birmingham, AL 35233
205-934-1777
janailston@uabmc.edu

Nina Jacobson, MD

1176 5th Avenue
New York, NY 10029
212-241-3703
ninamiz@gmail.com

Lisa Jambusaria, MD

B1100 Medical Center North
Nashville, TN 37232
615-343-8968
ljambusaria@yahoo.com

Rebecca James, MD

11100 Euclid Avenue LKS 5046
Cleveland, OH 44106
216-844-8570
Rebecca.James@uhhospitals.org

Kelly Jirschele, MD

1875 Dempster
Park Ridge, IL 60068
847-825-1590
kedavis75@aol.com

Sid Kamrava, MD

17525 Ventura Blvd., 101
Encino, CA 91316
818-783-5050
sk.rjSc@gmail.com

Gregg Kanter, MD

2211 Lomas Blvd. NE, Dept. of
OBGYN
Albuquerque, NM 87106
505-272-9712
gkanter@salud.unm.edu

Deborah Karp, MD

1639 Pierce Drive, Room 4305
Atlanta, GA 30322
debby.karp@emory.edu

Shunaha Kim-Fine, MD

4th Floor North Tower 1403 29th
Street NW
Calgary, AB 0
skima29@gmail.com

Cara King, DO

600 Highland Avenue
Madison, WI 53792
413-535-8220
cking8@wisc.edu

Casey Kinman, MD

550 S. Jackson St, 3rd Floor Dept
OBGYN
Louisville, KY 40202
817-680-0597
clkinm01@louisville.edu

Leise Knoepp, MD

Mc Farland Medical Office Building,
Ste 440, 4429 Clara St.
New Orleans, LA 70115
504-842-6457
lknoepp@gmail.com

Nicole Korbly, MD

101 Plain St., 5th Fl
Providence, RI 2903
401-453-7560
nbkorbly@gmail.com

— **Associate Members** —

Nathan Kow, MD

4075 Elnora Drive
Macon, GA 31210
478-633-5300
nathankow@gmail.com

Maryse Larouche, MD

Obstetrics and Gynecology
Vancouver, BC 0
maryse.larouche@gmail.com

Erin Lavelle, MD

300 Halket St
Pittsburgh, PA 15213
seifertee@upmc.edu

Alix Leader-Cramer, MD

250 E. Superior St., #05-2370
Chicago, IL 60611
312-472-3874
alix-leadercramer@northwestern.edu

Fiona Lindo, MD

OB/GYN Department-FPMRS
Temple, TX 76508
850-519-6960
feelindomd@gmail.com

Quinn Lippmann, MD

9350 Campus Point Drive, Ste 2A
MC 0974
La Jolla, CA 92307
919-357-3002
qlippmann@ucsd.edu

Annetta Madsen, MD

101 Plain Street
Providence, RI 2903
401-274-1122
annettamad@gmail.com

Leonidas Magarakis, MD

Kvinnokliniken Central Hospital of
Karlstad
Karlstad, Sweden 65185
460-546-71305
lemagarakis@gmail.com

Theofanis Manias, MD

University Hospital, Southmoor
Road
Manchester, UK 0
01204 2912954
theofanismanias@yahoo.co.uk

Shyama Mathews, MD

1176 Fifth Avenue, Box 1170
New York, NY 10029
212-434-2881
shyama.mathews@MOUNTSINAI.ORG

Donna Mazloomdoost, MD

3219 Clifton Ave, MOB Suite #100
Cincinnati, OH 45220
513-862-4171
Donna_Mazloomdoost@trihealth.com

Sukrant Mehta, MD

3332 Rochambeau Avenue
Bronx, NY 10467
sukrantmehta@gmail.com

Kate Meriwether, MD

2211 Lomas Blvd, NE
Albuquerque, NM 87131
505-249-5967
meriwet2@salud.unm.edu

Isuzu Meyer, MD

619 19th St South, 176F Suite
10382
Birmingham, AL 35249
205-996-9580
lmeyer@uabmc.edu

Jeannine Miranne, MD

500 Brookline Avenue Suite E
Boston, MA 2115
617-732-4838
Jmiranne@partners.org

Kavita Mishra, MD

101 Dudley St.
Providence, RI 2905
401-453-7560
kmishra@wihri.org

— Associate Members —

Shanti Mohling, MD

979 East Third Street
Chattanooga, TN 37403
shantimohling@gmail.com

Maggie Mueller, MD

250 E Superior St, Suite 5-2370
Chicago, IL 60611
312-472-3874
mmueller@nmff.org

Erin Murata, MD

MSC 10 5580, 1 University of New
Mexico
Albuquerque, NM 87131
emurata@salud.unm.edu

Emily Myer, MD

4940 Eastern Ave, 301 Bldg, Ste.
3200
Baltimore, MD 21224
410-550-7008
emyer3@jhmi.edu

John Navas, MD

1000 W. Carson St. Bldg D3 Box
489
Torrance, CA 90509
310-222-3868
jjnavas1607@icloud.com

Silpa Nekkanti, MD

395 W. 12th Ave. 5th floor
Columbus, OH 43210
silpa.nekkanti@osumc.edu

My-Linh Nguyen, MD

UCLA, 10833 Le Conte Ave, 27-
139 CHS
Los Angeles, CA 90095
mylinhnguyen@mednet.ucla.edu

Susan Oakley, MD

1400 North Grand Ave
Fort Thomas, KY 41071
859-757-2132
oakley.susan@gmail.com

Michelle Pacis, MD

500 University Drive; P.O. Box 850
Hershey, PA 17033
717-531-6447
mpacis@gmail.com

Chandhana Paka, MD

4940 Eastern Ave.
Baltimore, MD 21224
paka.chandhu@gmail.com

Andrey Petrikovets, MD

11100 Euclid Ave.
Cleveland, OH 44106
216-844-8570
andrepetrikovets@yahoo.com

Stephanie Pickett, MD

2017 West I-35 Frontage Road
Edmond, OK 73104
405-216-4004
stephdeterpickett@gmail.com

Oliver Preyer, MD

Paracelsusstrasse 8
Zell am See, Austria 0
oliver.preyer@gmail.com

Jameca Price, MD

3181 SW Sam Jackson Park Rd,
Mail Code: L466
Portland, OR 97239
503-494-3107
jamecaprice@gmail.com

Sharon Robertson, MD

3181 SW San Jackson Park Rd.
Portland, OR 97239
sharon.e.engel@gmail.com

Christina Saad, MD

8700 Beverly Blvd Rm 3622
West Hollywood, CA 90048
ChristinaAdelSaad@gmail.com

— Associate Members —

Jennifer Schmitt, DO

Gynecologic Surgery, Mayo Clinic
Rochester, MN 55905
schmitt.jennifer@mayo.edu

Ruchira Singh, MD

200 First Street SW
Rochester, MN 55901
507-284-2511
ruchira.26@gmail.com

Katelyn Smithling, MD

2480 16th St NW
Washington, DC 20009
202-877-6526
katelyn.smithling@gmail.com

Courtney Steller, DO

1st Floor, 1675 Dempster S
Park Ridge, IL 60068
courtney.steller@gmail.com

Maria Vargas, MD

2150 Pennsylvania Avenue Suite
6a-408
Washington, DC 20037
vickyvar55@gmail.com

Emily Von Bargaen, DO

725 Concord Ave
Cambridge, MA 2138
617-354-5452
Emily.vonbargaen@gmail.com

Megan N. Wasson, DO

5777 E Mayo Blvd
Phoenix, AZ 85054
480-342-0612
megan.wasson@gmail.com

Lauren Westermann, MD

690 Good Drive
Lancaster, PA 17604
717-544-0730
lwestermann2@lghealth.org

Kathryn Williams, MD

865 Northern Blvd Suite 202
Great Neck, NY 11021
516-622-5114
katshawill@gmail.com

Joshua Woelk, MD

205 S. Wabasha
Saint Paul, MN 55107
651-293-8117
Joshua.Woelk@Parknicollet.com

Sarah Woods, MD

385 Meadvale Rd.
Memphis, TN 38120
208-360-0185
woods.sarah.md@gmail.com

Emily Wu, MD

2401 South 31st St, MS-01-E316A
Temple, TX 76508
254-724-7588
emilykqwu@gmail.com

Allison Wyman, MD

3815 W. San Juan St
Tampa, FL 33629
440-227-2712
awyman@health.usf.edu

Jennifer Yeung, DO

3219 Clifton Ave, Suite 100
Cincinnati, OH 45220
jennifer_yeung@trihealth.com

Ladin Yurteri-Kaplan, MD

9103 Franklin Square Drive
Baltimore, MD 21237
443-77-8218
ladinyurterikaplan@gmail.com

Jessica Zigman, MD

1000 W Carson St Bldg D3
Torrance, CA 90509
Jszigman@gmail.com

— *Honorary Members* —

Anthony Atala, MD
Wake Forest Univ.
Winston-Salem, NC 27157

James Bagian, MD
21537 Holmbury
Northville, MI 48167

Sandra Carson, MD
409 12th Street, SW
Washington, DC 20024

William A. Cliby, MD
Mayo Clinic Dept. OB/GYN
Rochester, MN 55905

I. Kelman Cohen, MD
Medical College of Virginia
Richmond, VA 23298

Nancy W. Dickey, MD
147 Joe H. Reynolds Medical Bldg.
College Station, TX 77843

Norman F. Gant, MD
3425 Lookout Court
Grapevine, TX 76051

Alan E. Guttmacher, MD
Director, Eunice Kennedy Shriver,
NICHD
Bethesda, MD 20892

Katherine Hartmann, MD
2525 West End Ave., Suite 600
Nashville, TN 37203

Richard E. Hawkins, MD
ABMS
Chicago, IL 60601

Paul Hilton, MD
Directorate of Women's Services
Newcastle upon Tyne, UK 0

Shukri Khuri, MD
VA Boston Healthcare System
West Roxbury, MA 2132

Clifford Ko, MD
633 N. St Clair
Chicago, IL 60611

Heinz Koelbl, MD
Johannes-Gutenberg University
Mainz, Rhineland Palatinate
Rhineland Palatinate, Germany

Hal Lawrence, MD
409 12th Street SW
Washington, DC 20024

Susan Meikle, MD
8901 Wisconsin Ave
Bethesda, MD 20889

Ichiro Nagata, MD
Dept. OB/GYN, Saitama Medical
School
Saitama 359-0041, Japan

Ingrid Nygaard, MD
30 N 1900 East
Salt Lake City, UT 84132

Steven Palter, MD
246 Crossways Park Drive West
Woodbury, NY 11797

Ajay Rane, MD
3 Grange Court Belgian Gardens
Townsville, Australia 4810

Richard M. Satava, MD
University of Washington School of
Medicine
Seattle, WA 98111

— *In Memoriam* —

Michael Aronson, MD	Robert J. Luby, MD
Wayne F. Baden, MD	Abe Mickal, MD
Hugh R.K. Barber, MD	George W. Mitchell, MD
Robert H. Barter, MD	John McLean Morris, MD
John Brewer, MD	George W. Morley, MD
Herbert J. Buchsbaum, MD	David H. Nichols, MD
Edward B. Cantor, MD	Robert C. Park, MD
Joel Childers, MD	Roy T. Parker, MD
Sterling Crawford, MD	Warren E. Patow, MD
William E. Crisp, MD	Jack W. Pearson, MD
Charles Easterday, MD	Robert F. Porges, MD
Thomas Elkins, MD	Charles Powell, MD
Charles E. Flowers, MD	Joseph H. Pratt, MD
Edward G. Friedrich, Jr., MD	A. Cullen Richardson, MD
Donald G. Gallup, MD	Bobby A. Rimer, MD
Celso-Ramon Garcia, MD	Euan G. Robertson, MD
Caterina A. Gregori, MD	Stanley F. Rogers, MD
Marvin H. Terry Grody, MD	Keith P. Russell, MD
C. Paul Hodgkinson, MD	Thomas Russell, MD
Frederick J. Hofmeister, MD	Richard J. Scotti, MD
W. Powell Hutcherson, MD	David C. Sabiston, MD
W. Byron Inmon, MD	Martin L. Stone, MD
John Isaacs, MD	Donald P. Swartz, MD
Neil D. Jackson, MD	M. Leon Tancer, MD
George E. Judd, MD	Richard TeLinde, MD
Kermit Krantz, MD	John C. Weed, Jr., MD
Henry H. Lansman, MD	Charles A. White, MD
Stephen L. Larson, MD	George D. Wilbanks, MD
Thomas Leavitt, Jr., MD	Winfred Wiser, MD
Frederick Y.L. Lee, MD	Benjamin H. Word, MD
Raymond A. Lee, MD	James P. Youngblood, MD
William A. Little, MD	J. Benjamin Younger, MD
Oscar Litwak, MD	Robert F. Zacharin, MD

SGS thanks our premier sponsors for their support.

Diamond Sponsorship



Gold Sponsorship



Silver Sponsorship



Bronze Sponsorship



2016 Exhibitors

2016 Exhibitors

ACell
American Urogynecologic Society
Applied Medical
Boston Scientific
Bovie Medical Corporation
Caldera Medical
Cogentix Medical
Coloplast
Cooper Surgical
Cynosure
D. A. Surgical
ellura
Ethicon US, LLC
First Capital Benefit Advisors, Inc.
Focus Medical
Gaumard Scientific
Intuitive Surgical
Invuity, Inc.
KARL STORZ Endoscopy-America, Inc
LABORIE
Lumenis
Mallinckrodt Pharmaceuticals
Marina Medical Instruments
OBG Management
RESECTR - Distal Access
Richard Wolf Medical Instruments Corporation
Teva Pharmaceuticals
The Prometheus Group
Xodus Medical, Inc.

— 2016 Exhibitors —

ACell

Booth #5

MatriStem® Pelvic Floor Matrix products are biologically-derived devices comprised of Porcine Urinary Bladder Matrix (UBM). The matrix maintains an intact epithelial basement membrane, and facilitates the body's ability to form site-specific tissue. The product will resorb over time, leaving behind constructively remodeled tissue to continue supporting the patient's pelvic anatomy.

American Urogynecologic Society

Booth #7

AUGS is the premier non-profit organization representing more than 1,800 members including practicing physicians, nurse practitioners, physical therapists, nurses and health care professionals, as well as researchers from many disciplines, all dedicated to treating female pelvic floor disorders.

Applied Medical

Booth #8

Applied Medical is a new generation medical device company dedicated to providing breakthrough technologies that enhance patient outcomes while improving the affordability and accessibility of healthcare.

Applied is well recognized for its clinical advancements, including, GelPOINT® mini advanced access platform, Alexis® contained extraction system, and most recently, the Voyant® intelligent energy system.

Boston Scientific

Booths #11 and #12

Boston Scientific is dedicated to transforming lives through innovative medical solutions that improve the health of patients around the world. Please visit our exhibit to learn about our newest technology, Symphion™ Tissue Removal System along with our products for the treatment of menorrhagia, pelvic floor reconstruction, and female urinary incontinence.

Bovie Medical Corporation

Booth #24

Bovie® Medical will be featuring J-Plasma® the helium-based, gas plasma technology that is transforming the way surgeries are performed. J-Plasma® works with precision and versatility across open and laparoscopic procedures. Bovie will also exhibit its complete line of electrosurgical products.

— 2016 Exhibitors —

Caldera Medical

Booth #19

Caldera Medical is a Women's Health medical device company which focuses on improving the quality of life for women. Caldera Medical develops, manufactures and markets differentiated surgical implants for the treatment of Stress Urinary Incontinence (Desara® Sling System) and Pelvic Organ Prolapse (Vertessa® Lite).

Cogentix Medical

Booth #27

Cogentix Medical offers the following: Urgent® PC, a low-risk, office-based OAB treatment that provides clinically significant and durable results; PrimeSight™ endoscopy systems which combine high-performance imaging with the EndoSheath® protective barrier, a sterile, single-use product with an integrated working; and Macroplastique®, a proven bulking agent indicated for adult female SUI.

Coloplast

Booths #1 and #2

With a 50-year legacy of commitment and dedication to female pelvic health, Coloplast offers innovative solutions for the treatment of SUI and POP, featuring products such as the Altis® Single Incision Sling

System, Aris® and Supris® full length slings, Restorelle Smartmesh®, the Meridian Vaginal Positioning System, the Digitex® Suture Delivery System.

CooperSurgical

Booth #23

CooperSurgical is the leading provider of innovative medical devices and procedure oriented solutions that advance the standard of care for women. Our highly reliable and clinically relevant products and services facilitate the delivery of enhanced outcomes for your patients regardless of the clinical setting. Come visit our booth to interact with our industry leading solutions and experience why CooperSurgical is at the forefront of women's health care.

Cynosure

Booth #21

MonaLisa Touch is an innovative laser procedure, developed by DEKA International and distributed by Cynosure, that delivers fractional CO2 laser energy to the vaginal wall tissue. The procedure is performed in an office environment without the need for anesthesia and with virtually no pain or side effects.

— 2016 Exhibitors —

D.A. Surgical Booth #17

Dan Allen, inventor of booted stirrups, is presenting his newest patient positioning devices for Robotic/MIS surgery. TrenGuard™ remains the only Trendelenburg restraint that has never had a single report of patients sliding. ArmGuard™ is the only solution to AORN's "no tucking arms" guidelines. See PatientGuard™ Robot Stirrups too; they're awesome!

ellura

Booth #25

Only ellura™ contains 36 mg of PAC (proanthocyanidins) in one daily capsule and is proven effective as prophylactic therapy for patients with recurrent urinary tract infections (UTIs). Come by our booth to learn more about our non-antibiotic alternative for UTI management.

Ethicon US, LLC

Booth #30

Ethicon US LLC, a Johnson & Johnson company, commercializes a broad range of innovative surgical products, solutions and technologies used to treat some of today's most prevalent medical issues, such as: colorectal and thoracic conditions, women's health conditions, hernias, cancer and

obesity. Learn more at www.ethicon.com, or follow us on Twitter @Ethicon.

First Capital Benefit Advisors, Inc.

Booth #22a

Retirement Plans for Self Employed. We are actuaries providing retirement plans to self employed and small businesses (1-40), where the contributions and tax deductions are very significant for the owners. Our goal is to customize DB and 401k plans for our clients. We help you change your high income status to a high net worth status with our careful and cautious guidance. We do all the administration, testing, and IRS filings annually.

Focus Medical

Booth #14

Focus Medical has developed a line of best-in-class aesthetic lasers and light based devices marketed under the NaturaLase and NaturaLight brands.

— 2016 Exhibitors —

Gaumard Scientific Booth #13

Gaumard® provides innovative simulators for emergency care, nursing, OB/GYN, and surgery worldwide as part of our global commitment to healthcare education. In 2004, Gaumard introduced the first of its growing family of tetherless simulators, which now includes HAL®, Victoria™, NOELLE®, Susie®, two Pediatrics, and two Newborn simulators. All are controlled from a wireless tablet PC.

Intuitive Surgical Booths #9 and #10

Intuitive Surgical is the global leader in minimally invasive, robotic-assisted surgery. Its *da Vinci*® Surgical System – with a 3D-HD vision system and *EndoWrist*® instrumentation – enables surgeons to offer a minimally invasive approach for a range of complex procedures. *da Vinci* is used in more than 2,500 hospitals around the world.

Invuity, Inc. Booth #18

Invuity is a medical technology company focused on pioneering the use of advanced photonics to provide surgeons with improved direct visualization of surgical cavities during open

minimally invasive and minimal access procedures.

KARL STORZ Endoscopy- America, Inc.

Booth #16

KARL STORZ has remained a leader in minimally invasive endoscopy products for nearly 70 years and offers a range of exceptional gynecological products. Among our technology solutions are EndoCAMEleon® laparoscopes with variable direction of view, RoBi® bipolar laparoscopic forceps, trauma-reducing minilaparoscopy instrument sets, and state-of-the-art OR and office hysteroscopy equipment.

LABORIE

Booth #28

LABORIE, the global leader in pelvic health diagnostics, brings freedom and dignity to patients suffering from pelvic floor disorders through innovation in diagnostic and treatment options. LABORIE's product line includes solutions for Urodynamics, Anorectal Manometry, Uroflowmetry, Clinical Informatics, Ultrasound and Pelvic Floor Rehabilitation.

— 2016 Exhibitors —

Lumenis

Booth #29a

Lumenis® is the world's largest medical laser company. Lumenis offers the Acupulse with Fem Touch for treatment of vaginal health related conditions.

Mallinckrodt Pharmaceuticals

Booth #29

Mallinckrodt Pharmaceuticals is an industry leader in providing specialty biopharmaceutical products used in the treatment of autoimmune and rare disease specialty areas, respiratory therapies, pain and related conditions, and diagnostic procedures. The company's three segments include branded medicines and devices, generic drugs and medical imaging. Visit www.mallinckrodt.com to learn more.

Marina Medical Instruments

Booth #22

Marina Medical designs, manufactures, and distributes medical devices for the plastic, aesthetic, reconstructive, and regenerative medicine fields of surgery. Our innovative product line consists of aesthetic surgery instrumentation and our premium lipoplasty products, which include Koume cannulas

and lipoplasty accessories. Se habla español. Falamos Português.

OBG Management

Booth #3

OBG Management offers evidence-based best practices in print and online that help ObGyns provide optimal patient care. Led by Editor-in-Chief Robert L. Barbieri, MD, print editorial is reinforced by technique videos and audio commentary at www.obgmanagement.com. Topics include surgical and diagnostic techniques, standards of care, new technologies, medicolegal and practice-management information, and more.

RESECTR – Distal Access

Booth #15

RESECTR™ High-Performance Tissue Resection. The RESECTR is a cost-efficient 100% disposable tissue resection system. RESECTR's award winning technology allows users to control cutting speed & force with their hand and can be used in the hospital, clinic, surgery center, or office. The system does not require new capital equipment. www.RESECTR.com.

— 2016 Exhibitors —

**Richard Wolf Medical
Instruments Corporation**

Booth #20

We are a global business with headquarters in Germany and over a century of tradition and expertise in the field of endoscopy. We develop, manufacture and market specific system solutions for minimally invasive human medicine.

Teva Pharmaceuticals

Booth #4

The Prometheus Group

Booth #26

NEW: Wireless Digital Endoscope Camera and LED Light Source. Morpheus System with 360 Endorectal Ultrasound, Abdominal Ultrasound for Bladder, Renal and Aorta Imaging, Complex Urodynamics, Anorectal Manometry with Paradoxical EMG, Pelvic Muscle Rehabilitation. QuickScan Bladder Ultrasound. See how you can turn your PC into an endoscopy system.

Xodus Medical, Inc.

Booth #6

Xodus Medical is making gynecological surgery safer with The Pink Pad XL advanced patient positioning system, the innovative, clinically-preferred product for increasing patient safety in Trendelenburg preventing unwanted patient movement, while protecting skin and nerves from injury and pressure-related complications. See the new One-Step face and arm protectors.

— *SGS Administrative Staff* —

Nancy Frankel, PhD
Executive Director
nancy@sgsonline.org

Lennie Siegel, BBA, CPA
Meeting Manager
lennie@sgsonline.org

Melinda Letterman
Executive Administrator
melinda@sgsonline.org

Mailing Address
7800 Wolf Trail Cove
Germantown, TN 38138

Phone
(901) 682-2079

Fax
(901) 682-9505

Website
www.sgsonline.org





Proven product legacy

Same mesh material as used in the Aris® and Supris® sling systems

Predictable placement

Holical type introducer allows for ease of passage and placement

Precise adjustability

Anchoring allows for bi-directional tensioning

www.AltisSIS.com

The results are in. Visit our booth to review the IDE clinical data and receive a product demonstration.



Indications: The Altis Single Incision, Aris Transdurotensor and Supris Retrocure Sling Systems are indicated for the treatment of female stress urinary incontinence (SUI) resulting from urethral hypermobility and/or intrinsic sphincter deficiency (ISD). **Contraindications:** Altis, Aris or Supris slings should not be used in pregnant women, or in women planning future pregnancies or any patient with potential for future growth. Altis, Aris or Supris slings should not be used in those who are taking anticoagulant therapy, who have an abnormal urethra, who have an intra-operative urethral injury, are immunocompromised, who have a sensitivity to polypropylene, have a pre-existing local or systemic infection, who are immunocompromised, or women that have a known or suspected pathology which would compromise implant or implant placement. **Warnings and Precautions:** It is the responsibility of the surgeon to advise the prospective patients or their representatives, prior to surgery, of the possible warnings and precautions associated with the use of this product and the associated surgical risks. Altis, Aris and Supris Sling Systems should only be used by surgeons familiar with the surgical procedures and techniques involving transvaginal placement of non-absorbable meshes and who have adequate education and experience in the treatment of female SUI. Based on physician experience and education, a thorough assessment of each patient should be made to determine the suitability of a synthetic mesh procedure. The patient should be counseled that alternative non-mesh incontinence surgeries may be appropriate, and the reason for choosing a mesh procedure should be explained. Physician should obtain patient consent prior to surgery and ensure that the patient has an understanding of the possible risks and potential complications of transvaginal mesh surgery. Patient counseling should include a discussion that the mesh to be implanted is a permanent implant, and that some complications associated with the implanted mesh may require additional surgery; repeat surgery may not resolve these complications. Serious adverse tissue responses or infection may require removal of mesh. **Adverse Effects:** Potential adverse events are those associated with surgery using implantable synthetic mesh materials. As with all foreign bodies, the Altis, Aris, Supris sling is likely to exacerbate any existing infection. Local irritation at the wound site and/or a foreign body response may occur. The following complications are known to occur with synthetic mesh implantation: mesh erosion (e.g., vaginal, bladder), mesh extrusion, mesh exposure, infection, pain (acute or chronic), and bladder, bowel, urethra, vagina, vessel, and/or nerve perforation/injury. There is also the risk of complete failure of the procedure resulting in continued incontinence due to incomplete support or overactive bladder. The occurrence of these events may require partial or complete removal of the sling. Patients should be monitored regularly after the device has been implanted for immediate treatment of any adverse reaction.

See the device instructions for use for detailed information regarding the implant procedure, warnings/precautions, adverse reactions, prior to using this product.

For further information, call Coloplast Corp. at 1-800-258-3476 and/or consult the company website at www.coloplast.us.

CAUTION: Federal (USA) law restricts this device to sale by, or on, the order of a physician.

www.coloplast.us

The Coloplast logo Altis, Aris, and Supris are registered trademarks of Coloplast A/S.
© 2016. All rights reserved. Coloplast Corp., Minneapolis, MN USA.



***43rd SGS Annual Scientific Meeting
March 26-29, 2017***

***La Cantera Hill Country Resort
San Antonio Hill Country, Texas***

